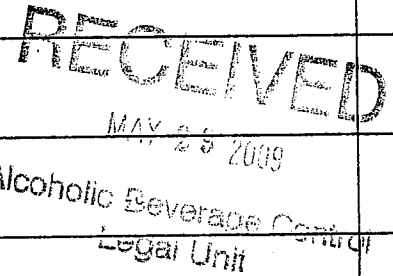

**DEPARTMENT OF ALCOHOLIC BEVERAGE CONTROL
ADMINISTRATIVE HEARING OFFICE**

EXHIBIT LIST

CASE NAME: Bear River Casino

DATE	CITY	TIME	PAGES	COURT REPORTER															
4-29-09	Eureka	7.0 Hrs.	180	Katherine Wayne – Atkinson-Baker Court Reporters															
ADMIN. LAW JUDGE			FILE NO.	REG. NO.															
John W. Lewis			47-423392	08 070 211															
COMPLAINANT				RESPONDENT(S) ATTORNEY															
Noel Krahforst				Michael Acosta															
DEPARTMENT EXHIBITS				RESPONDENT(S) EXHIBITS															
				I D	E V I D	A H S Y	R E M	I D	E V I D	A H S Y	R E M								
1.	Pleadings for jurisdiction			X	X			A.	Intersection design			X	X						
2.	Petition for conditional license			X	X			B.	Bureau of Indian Affairs letter			X	X						
3.	Dept. Public Works letter			X	X			C.											
4.	Letter, MOA & diagram			X	X			D.											
5.	Congressman Thompson letter			X	X			E.											
6.	A through E Photos			X	X														
7.	ABC-257 for T-47 license			X	X							PROTESTANTS' EXHIBITS							
8.	ABC-257 for T-20 license			X	X							I.							
9.												II.							
10.												III.							
11.												IV							
12.												V.							
13.								VI.											
								VII.											

ID-marked for ident.; EVID-admitted into evidence; AHSY-admitted as administrative hearsay; REM-remanded exhibit

AWO

BEFORE THE
DEPARTMENT OF ALCOHOLIC BEVERAGE CONTROL
OF THE STATE OF CALIFORNIA

IN THE MATTER OF THE ACCUSATION AGAINST:

Bear River Casino
Bear River Casino
11 Bear Paws Way
Loleta, CA 95551-9684

ON-SALE GENERAL PUBLIC EATING PLACE LICENSE

FILE : 47 - 423392

REG. : 08070211

NOTICE OF HEARING
ON ACCUSATION

under the Alcoholic Beverage Control Act.

To the parties in the above-entitled proceeding:

YOU ARE HEREBY NOTIFIED THAT A HEARING on accusation filed December 24, 2008, will be held before an Administrative Law Judge at the **Humboldt Yacht Club, #1 Waterfront Drive, Eureka** on **April 29, 2009 and April 30, 2009**, at the hour of **10:00 AM** or as soon thereafter as the matter can be heard, upon the charges made in the aforesaid accusation.

If you object to the place of hearing, you must notify the presiding officer within 10 days after this notice is served on you. Failure to notify the presiding officer within 10 days will deprive you of a change in the place of the hearing. You may be present at the hearing. You have the right to be represented by an attorney at your own expense. You are not entitled to the appointment of an attorney to represent you at public expense. You are entitled to represent yourself without legal counsel. You may present any suitable evidence and will be given full opportunity to cross-examine all witnesses testifying against you. You are entitled to the issuance of subpoenas to force the attendance of witnesses and the showing of books, documents or other things.

The hearing may be postponed for good cause. If you have good cause, you are obligated to notify the agency within 10 working days after you discover the good cause. Failure to notify the agency within 10 days may deprive you of a postponement. For information regarding continuances, please call 916-419-2517.

The hearing will be conducted in English. If you need language assistance, it is your responsibility to provide, at your own cost, a court certified interpreter. Information on certified court interpreters may be obtained from: Administrative Office of the Courts, Court Interpreters Program, 455 Golden Gate Avenue, San Francisco, CA 94102-3688. Information may also be obtained at 1-866-310-0689 or on line at www.courtinfo.ca.gov/programs/courtinterpreters/ctintdb.cfm. You may ask for the issuance of subpoenas (for parties representing themselves) by applying to the Department of Alcoholic Beverage Control at the nearest Division Office or to Department Headquarters in Sacramento. An attorney representing a party shall issue his/her own subpoena(s) in compliance with Government Code Section 11450.20 in accordance with Sections 1985 to 1985.4, inclusive of the Code of Civil Procedure.

RECEIVED

MAR 18 2009

Administrative Hearing Office
Dept. of Alcoholic Beverage Control

Dated at Sacramento, California -- March 17, 2009

DEPARTMENT OF ALCOHOLIC BEVERAGE CONTROL

Helen McConville

Helen McConville

Supervisor, Hearing & Legal

(916) 419-2551

**BEFORE THE
DEPARTMENT OF ALCOHOLIC BEVERAGE CONTROL
OF THE STATE OF CALIFORNIA**

IN THE MATTER OF THE ACCUSATION AGAINST:

Bear River Casino
Bear River Casino
11 Bear Paws Way
Loleta, CA 95551-9684

ON-SALE GENERAL PUBLIC EATING PLACE LICENSE

FILE : 47 - 423392

REG. : 08070211

**DECLARATION OF
SERVICE BY MAIL**

under the Alcoholic Beverage Control Act.

The undersigned declares:

I am over eighteen years of age, and not a party to the within cause; my business address is 3927 Lennane Drive, Suite 100, Sacramento, California 95834. I served by **REGULAR** mail a copy of the following documents:

NOTICE OF HEARING ON ACCUSATION

on each of the following, by placing same in an envelope(s) addressed as follows:

**Bear River Casino
Bear River Casino
11 Bear Paws Way
Loleta, CA 95551-9684**

**Bear River Casino
32 Bear River Drive
Loleta, CA 95551**

**Noel Krahforst
525 Singley Hill Road
Loleta, CA 95551**

Each said envelope was then, on March 17, 2009 sealed and deposited in the United States mail at Sacramento, California, the county in which I am employed, with the postage thereon fully prepaid.

I declare under penalty of perjury that the foregoing is true and correct.

Executed on March 17, 2009 at Sacramento, California.

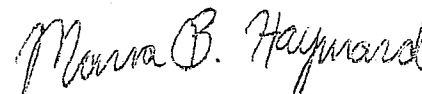

Maria Hayward, Declarant

Eureka District Office(interoffice mail)

Division Office(interoffice mail)

BEFORE THE
DEPARTMENT OF ALCOHOLIC BEVERAGE CONTROL
OF THE STATE OF CALIFORNIA

the Matter of the Accusation Against: **FILED**

File: 47-423392

BEAR RIVER CASINO

DEC 24 2008

Reg: **08070211**

DBA: Bear River Casino
PREMISES: 11 Bear Paws Way
Loleta, CA 95551

ALCOHOLIC BEVERAGE CONTROL

ACCUSATION UNDER
ALCOHOLIC BEVERAGE
CONTROL ACT AND
STATE CONSTITUTION

LICENSE(S): On-Sale General (Eating Place)

I hereby complain and accuse the above respondent(s), holding the above license(s), based on the following statement of facts:

COUNT 1

From July 26, 2006 to the present, respondent-licensee violated a condition placed upon the license, in violation of Business and Professions Code Section 23804 and other applicable California laws, compacts, codes and regulations, to wit: The licensee shall modify the entrance from Singley Road to Bear River Drive so that public vehicular ingress and egress is available only to and from the south on Singley Road. The modified entrance or a separate entrance shall provide access to the premises from the north on Singley Road for emergency vehicles only.

COUNT 2

From September 4, 2008, respondent-licensee violated a condition placed upon the license, to wit: The licensee shall exercise no off-sale privileges pursuant to Business and Professions Code section 23401, in violation of Business and Professions Code Section 23804 and other applicable California laws, compacts, codes and regulations.

Licensee(s) Previous Record: Licensed as above since July 26, 2006, with no record of disciplinary action.

(1) That by reason of the foregoing facts; and facts stated in the Singley Hill Homeowners' September 9, 2008 letter to Robert Farrar; and by reason of facts presented at previous protest hearings regarding the above license and facts documented in the attached exhibits, grounds for suspension or revocation of such license(s) exist and the continuance of such license(s) would be contrary to public welfare and morals, as set forth in Article XX, Section 22, State Constitution, and Section(s) 24200 (a) & (b) of the Business and Professions Code, and in violation of other applicable California laws, compacts, codes and regulations;

(2) WHEREFORE, I request that a hearing be held on this accusation.

Dated this 15 day of DECEMBER 2008

Noel Krahforst

Noel Krahforst
Representative of the Singley Hill
Homeowners Association
525 Singley Hill Road
Loleta, CA 95551

RECEIVED

DEC 17 2008

Attached Exhibits:

Hearing and Legal Unit
Dept. of Alcoholic Beverage Control
SACRAMENTO

1. April 22, 1996 County letter to Tribe for encroachment permit
2. October 1999 Winzler & Kelly engineering consultants, mitigation measures 16-2a, 16-3
3. August 8, 2004 Lou Costa letter to tribal council
4. May 2005 ABC license application and Karen Locken investigation report
5. January 24, 2005 Leonard Bowman letter to Mr. Costa
6. January 24, 2005 Calkins letter to ABC
7. March 4, 2005 Tribe letter to County Public Works
8. July 24, 2006 Bear River Casino conditional license
9. August 14, 2006 Acosta letter to Homeowners Association with proposed design & agreement
10. E-mails "a" through "h"
11. May 27, 2008 Laco Associates Bear River Drive /Singley Road "Roundabout" design
12. May 27, 2008 Laco Associates Bear River Drive /Singley Road intersection "Plan"
13. August 4, 2008 Humboldt County speed hump survey cover letter
14. October 24, 2008 Congressman Thompson letter to BIA Regional Director
15. September 9, 2008 letter from Single Hill Homeowners to ABC
16. November 18, 2008 ABC Stephen Hardy letter to Congressman Mike Thompson
17. Google aerial photo casino expansion and former casino employee parking
18. Google aerial photo Singley Rd. directly north of casino
19. Google aerial photo north end Singley Rd
20. December 2008 photo off-sale outlet and casino
21. December 2008 Photo mini-mart/gas station marquee
22. CD with audio file Robert Farrar September 2008 statement regarding license conditions

STATEMENT TO RESPONDENT^)

Unless a written request for a hearing, signed by you, or on your behalf, is delivered, or mailed, to the Department of Alcoholic Beverage Control within fifteen (15) days after the foregoing accusation was personally served on you or mailed to you, the Department of Alcoholic Beverage Control may proceed upon the accusation without a hearing to take action thereon as provided by law. The request for a hearing may be made by delivering or mailing the enclosed form entitled: "Notice of Defense", or by delivering or mailing a Notice of Defense to the Department of Alcoholic Beverage Control, 3927 Lennane Drive, Suite 100, Sacramento, California 95834, as provided by Section 11506 of the Government Code. The "Notice of Defense" forwarded herewith, if signed and returned to the Department of Alcoholic Beverage Control, shall be deemed a specific denial of all parts of the accusation, but you will not be permitted to raise any objection to the form of the accusation, unless you file a further Notice of Defense as provided, in Section 11506 of the Government Code within said 15 days after service of said accusation upon you. At any or all stages of these proceedings, you have the right to be represented by counsel at your own expense or to represent yourself without legal counsel. You are not entitled to the appointment of an attorney to represent you.

The hearing may be postponed for good cause. If you have good cause, you are obliged to notify this agency within 10 working days after you discover the good cause. Failure to notify this agency within 10 days will deprive you of a postponement

SINGLEY HILL HOMEOWNERS
ASSOCIATION
525 Singley Hill Rd.
Loleta, CA 95551

RECEIVED

DEC 18 2008

Dept of Alcoholic Beverage Control
Director's Office

December 15, 2008

Department of Alcohol Beverage Control Hearing & Legal Unit
Attn: Helen McConville, Supervisor
3927 Lennane Drive, Suite 100

Re: Accusation Against:
Bear River Casino
FILE: 47-423392

Dear Ms. McConville:

Enclosed is an accusation signed by me on behalf of the Singley Hill Homeowners Association pursuant to a request for a hearing.

We respectfully request that a hearing *not* be scheduled before January 31, 2009 because of prior commitments by association members in January as well as numerous travel and holiday plans.

If you have any questions, please call me at:
707-733-1953 or Louis & Antoinette Ballister at 707-733-9401.
Notices can be sent to the address below.

Noel Krahforst

Noel Krahforst
for the Singley Hill Homeowners Association
525 Singley Hill Rd.
Loleta, CA 95551

c: Cheryl Schmidt, Director Stand Up for California
Jimmy Smith, Humboldt County 1st District Supervisor

RECEIVED

DEC 17 2008

Hearing and Legal Unit
Dept. of Alcoholic Beverage Control
SACRAMENTO

BEFORE THE
DEPARTMENT OF ALCOHOLIC BEVERAGE CONTROL
OF THE STATE OF CALIFORNIA

IN THE MATTER OF THE PROTEST OF:

Antoinette Ballister, et al
P.O. Box 591
Lolita CA 95551-0591

AGAINST THE PERSON TO PERSON AND PREMISES TO
PREMISES TRANSFER OF AN ON-SALE GENERAL PUBLIC
EATING PLACE LICENSE TO:

Bear River Casino
11 Bear Paws Way
Lolita, CA 95551

FILE : 47 - 423392

REG. : 05060025

DECLARATION OF
SERVICE BY MAIL

Under the Alcoholic Beverage Control Act.

ORDER

The protestants having withdrawn their protests against the issuance of the above license provided that the license be issued under certain conditions, the protests are hereby dismissed, effective immediately.

Said Petition for Conditional License dated July 14, 2006 is attached hereto and hereby incorporated herein as though set forth in full. Pursuant to Section 23802 the licensee(s) shall attach the Petition to the license certificate.

CERTIFICATE

It is hereby certified that on July 24, 2006, the Department of Alcoholic Beverage Control adopted the foregoing as its order in the proceeding therein described.

Sacramento, California

Dated: July 24, 2006

Judy Carlton

Supervisor, Hearing & Legal Unit

Blumberg No. 5119

EXHIBIT

2

RECEIVED

JUL 17 2006

Dept of Alcoholic Beverage Control
Legal Unit

BEFORE THE
DEPARTMENT OF ALCOHOLIC BEVERAGE CONTROL
OF THE STATE OF CALIFORNIA

IN THE MATTER OF THE APPLICATION OF

BEAR RIVER CASINO
Dba Bear River Casino
11 Bear Paws Way
Loleta, CA 95551

} FILE : 47-423392

}

} REG:

}

}

} PETITION FOR CONDITIONAL
} LICENSE

}

}

For Issuance of an On-Sale General Eating Place License

Under the Alcoholic Beverage Control Act

WHEREAS, petitioner has filed an application for the issuance of the above-referred-to license for the above mentioned-premises; and,

WHEREAS, the petitioner's parent entity, Bear River Band of the Rohnerville Rancheria, has entered into a Tribal - State Gaming Compact with the State of California; and,

WHEREAS, the petitioner is operating Class III gaming devices as defined by 25 U.S.C. Sec. 2703 (8) on the applied-for premises; and,

WHEREAS, the petitioner wishes to permit consumption of alcoholic beverages in a portion of the gaming facility where Class III Gaming Activities will be conducted and,

WHEREAS, persons under the age of 21 years cannot be present in any area in which Class III Gaming and the consumption of alcoholic beverages occur; and,

WHEREAS, the proposed premises and/or parking areas, operated in conjunction therewith, are located within close proximity to nearby residences; and,

WHEREAS, the Department of Alcoholic Beverage Control finds the issuance of an unrestricted license, at this time, would be contrary to public welfare and morals;

NOW, THEREFORE, the undersigned petitioner does hereby petition for a conditional license as follows:

1. No persons under the age of 21 shall be allowed in any Class III gaming areas where consumption of alcoholic beverages is permitted, except that employees not engaged in the sale or service of alcoholic beverages shall be permitted to be in such areas in the performance of their duties as employees.

Any other person under the age of 21 years may be permitted in the Class III gaming area(s) in which alcoholic beverages are allowed by the petitioner(s) to be consumed, only while en-route to other areas in the licensed premises.

2. The applicant shall report to the Department in writing any changes in members of the elected tribal council. The report shall be made within 30 days of said change.
3. There shall be no exterior advertising or sign of any kind or type, including advertising directed to the exterior from within, promoting or indicating the availability of alcoholic beverages. Interior displays of alcoholic beverages or signs which are clearly visible to the exterior shall constitute a violation of this condition.
4. Entertainment provided shall not be audible beyond the area under the control of the licensee as defined on The ABC-257 dated 2-15-05 and ABC-253 dated 2-15-05 to include the parking lot unless an Event Permit Authorization to include entertainment is authorized.
5. Sales, service and consumption of alcoholic beverages shall be permitted only between the hours of 10:00 a.m. until 2:00 a.m., seven days a week.
6. At any time the premises are exercising their license privilege, the petitioner shall provide two (2) uniformed security guards to maintain order and respond to any disturbance inside or outside the premises or in the parking lot areas under control of the petitioner. The premises parking areas shall be patrolled no less than every hour.
7. The licensee shall widen and improve Singley Road for the 0.3 mile between the premises and the US 101 interchange to meet Humboldt County standards.
8. The licensee shall modify the entrance from Singley Road to Bear River Drive so that public vehicular ingress and egress is available only to and from the south on Singley Road. The modified entrance or a separate entrance shall provide access to the premises from the north on Singley Road for emergency vehicles only.

9. The licensee shall exercise no off-sale privileges pursuant to Business and Professions Code section 23401.

This petition for conditional license is made pursuant to the provisions of Sections 23800 through 23805 of the Business and Professions Code and will be carried forward in any transfer at the applicant-premises.

Petitioner agrees to retain a copy of this petition on the premises at all times and will be prepared to produce it immediately upon the request of any peace officer.

The petitioner understands that any violation of the foregoing condition(s) shall be grounds for the suspension or revocation of the license(s).

DATED THIS 14th DAY OF July, 2006.

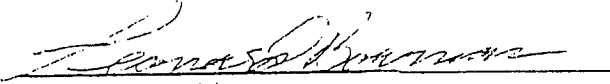
Applicant/Petitioner
Leonard Bowman

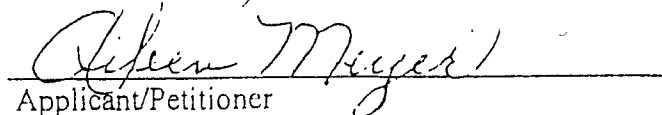
Applicant/Petitioner
Aileen Meyer

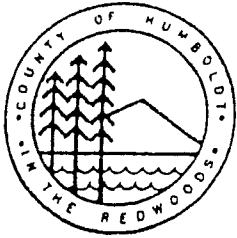

Handwritten: Stand & Deliver
FYI
Signature

DEPARTMENT OF PUBLIC WORKS
COUNTY OF HUMBOLDT

MAILING ADDRESS: 1106 SECOND STREET, EUREKA, CA 95501-0579
AREA CODE 707

ARCATA-EUREKA AIRPORT TERMINAL
McKINLEYVILLE
839-5401

PUBLIC WORKS BUILDING SECOND & L ST., EUREKA			
ADMINISTRATION	445-7491	NATURAL RESOURCES	445-7741
BUSINESS	445-7652	PARKS	445-7652
ENGINEERING	445-7493	ROADS & EQUIPMENT MAINT.	445-7421

CLARK COMPLEX
HARRIS & H ST., EUREKA
REAL PROPERTY SERVICES 445-7203

April 22, 1996

RECEIVED
BOARD OF SUPERVISORS

APR 23 1996

AM PM
7|8|9|10|11|12|1|2|3|4|5|6

Barbara Orr
Tribal Administrator
Bear River Mattole Wiyot Tribe
P. O. Box 108
Eureka, CA 95502-0108

RE: PROPOSED SINGLEY ROAD CASINO



Please be advised that this office is responsible for Singley Road and any encroachments for access on to it. At the present time, you have been issued an encroachment permit for your housing development. Please do not construe this permit as being expandable to include other uses such as a casino that is contemplated. The traffic that would be generated by such a use is significantly larger than the present use.

Please be advised that our County Code requires an encroachment permit for the Tribe to gain access to the County road. We do not intend to use this ordinance as a means of controlling your project but only to assure that our road will be able to adequately serve whatever is ultimately constructed.

Our requirements to issue a permit such as you will need will require an engineered traffic study to indicate the volume of traffic you will generate, an examination of the structural section capabilities of Singley Road and its south terminus with the Highway 101 off-ramp, and possibly northerly if the traffic study indicates the need. Any improvements necessary for the projected traffic volume would have to be constructed as a condition of issuance of the encroachment permit and must be completed prior to occupancy of use.

EXHIBIT
3
imburg No. 5119

If you have any questions in this regard, please contact Harless McKinley of my staff at 445-7205.

Very truly yours,

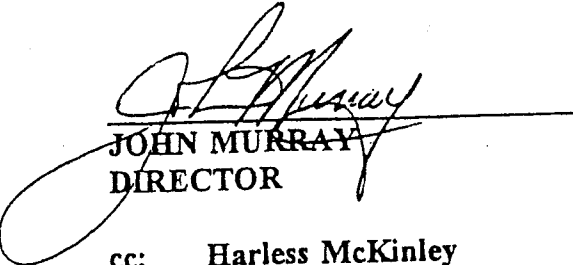

JOHN MURRAY
DIRECTOR

cc: Harless McKinley
bcc: Supervisor Dixon
County Administrative Officer
Tamara Falor
Tom Conlon
Jeff Arnold



BEAR RIVER BAND of ROHNERVILLE RANCHERIA

27 BEAR RIVER DR. LOLETA, CA 95551 707.733.1900, fax 733.1972



August 14, 2006

Singley Hill Homeowners Association

RE: Side Agreement-ABC liquor license proceeding

Dear Residents of Singley Hill,

Enclosed are a draft Memorandum of Agreement between the Singley Hill Homeowner Association and the Bear River Casino addressing timelines and designs for the improvement of Singley Road. The agreement is a draft and is neither approved nor signed by the Casino at this point. The enclosed drawing has been reviewed by the Tribal Council and is pending review by the County of Humboldt. The drawing, in my opinion, adds more than was discussed at the hearing, since it includes both an island in Bear River Drive and a center divider on Singley Road to make egress northbound virtually impossible and ingress extremely difficult. This is the very best our engineer could do and satisfies condition 8 of the liquor license; however, I must reiterate that the County has not yet agreed to the idea of a center divider on Singley Road. We will, with your assistance, push for this design as it is the most restrictive design achievable. If approved, this entrance redesign will be included in the 30 day comment period related to the road improvement.

We have recently completed the hydrological report related to the road improvement and will be submitting the same to the Army Corps of Engineers shortly. Once submitted, the Army Corps may take a couple of months to agree or disagree with our report. This means that construction will likely begin in early spring 2007, rather than this construction season, as was previously hoped.

Please feel free to contact me if you have any questions or concerns.

Sincerely,

Michael P. Acosta



**MEMORANDUM OF AGREEMENT BETWEEN THE SINGLEY HILL
HOMEOWNERS ASSOCIATION
AND THE BEAR RIVER CASINO**

The Bear River Casino (hereinafter referred to as the "Casino") and the Singley Hill Homeowner's Association (hereinafter referred to as the "Association") hereby enter into this Memorandum of Agreement to facilitate implementation of conditions added to the Casino's Type 47 liquor license by the California Department of Alcoholic Beverage Control (ABC).

The Casino agrees that it will have the southern portion of Singley Road, consisting of approximately three tenths of a mile, improved by August 30, 2007, in satisfaction of liquor license condition number seven (7). The parties hereto acknowledge that said improvement of Singley Road is subject to approval by the County of Humboldt, Caltrans, and the Army Corps of Engineers, and that additional time may be necessary if one or more of the government agencies delays construction. The Casino agrees to provide updates to the Association regarding government approvals and public comment periods.

The Casino further agrees that during construction of the Singley Road improvement, the contractor selected will keep one lane open to traffic at all times.

The parties hereto further agree that the Casino shall improve the entrance to Bear River Drive according to the attached drawing, in satisfaction of the liquor license condition number eight (8). The parties hereto acknowledge that said improvement is also subject to approval by the County of Humboldt and the Bureau of Indian Affairs, and that changes to the attached design may be required by one or both of those agencies.

The parties hereto agree to meet and confer regarding any modifications required by or delays caused by any government agency. The parties hereto further agree that if a disagreement shall arise in relation to the above promises, the parties shall participate in mediation in the County of Humboldt with a mediator mutually selected by the parties. The parties further agree that if mediation fails to resolve the disagreement, then the parties will pursue remedies available through the Department of Alcoholic Beverage Control (ABC).

SINGLEY HILL HOMEOWNERS ASSOCIATION by NOEL KRAHFORST

By: _____ Date: _____
Noel Krahforst

BEAR RIVER CASINO by Leonard Bowman

By: _____ Date: _____
Leonard Bowman, Chairman
Bear River Casino

EXHIBIT 1 - PROPOSED INTERSECTION

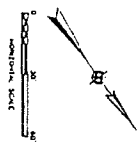
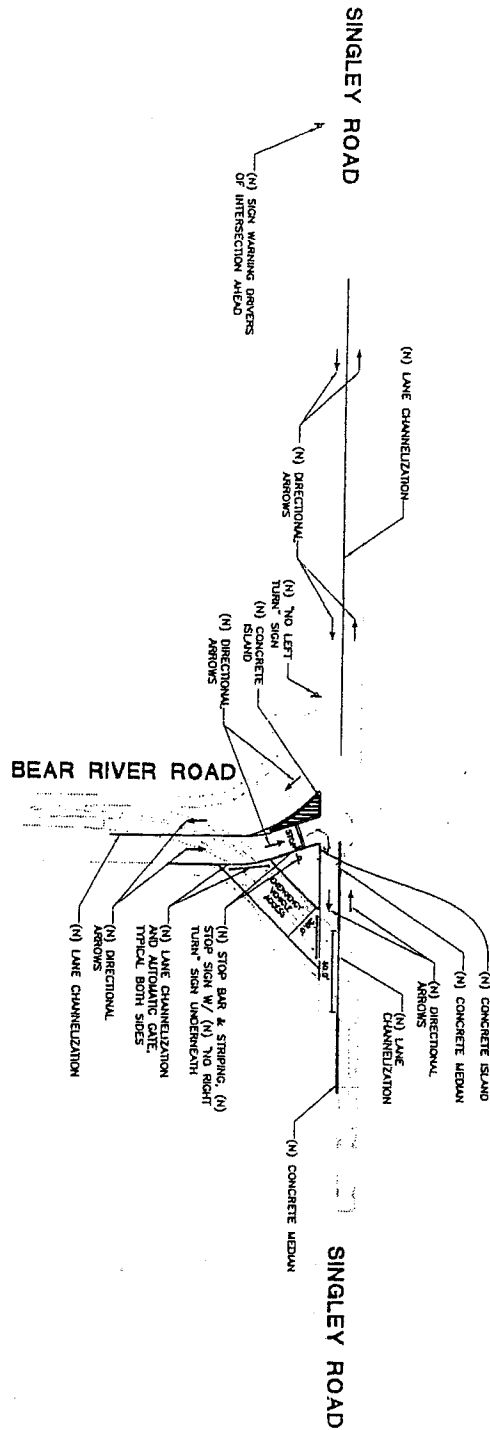

(N) SIGN WARNING DRIVERS
PLACED ON CREST OF CURVE

C:\Users\jgibson\Documents\Projects\11-08_Signs_and_Intersection_Design\11-08_Signs_and_Intersection_Design.dwg 7/26/2008

BEAR RIVER BAND SINGLEY ROAD INTERSECTION DESIGN CIVIL EXHIBIT 1 PROPOSED INTERSECTION	DATE: 07/26/2008 DRAWN BY:	WINZLER KELLY CONSULTING ENGINEERS 832 THIRD STREET CUMMINGS, CA 95306-0417 TEL (707) 443-8218 FAX (707) 444-8220	REVISIONS NO. DESCRIPTION DATE BY
	PROJECT: EX-1 DRAWING SCALE AS NOTED	PROJECT NO.: SHEET NO.:	CHECKED BY: DATE:

MIKE THOMPSON

1ST DISTRICT, CALIFORNIA

COMMITTEE ON WAYS AND MEANS

SUBCOMMITTEE ON HEALTH

SUBCOMMITTEE ON SELECT
REVENUE MEASURES

PERMANENT SELECT
COMMITTEE ON INTELLIGENCE

CHAIRMAN, SUBCOMMITTEE ON TERRORISM,
HUMAN INTELLIGENCE, ANALYSIS AND
COUNTERINTELLIGENCE

SUBCOMMITTEE ON INTELLIGENCE COMMUNITY
MANAGEMENT



CONGRESS OF THE UNITED STATES
HOUSE OF REPRESENTATIVES
WASHINGTON, DC 20515

DISTRICT OFFICES:
1040 MAIN STREET, SUITE 101
NAPA, CA 94559
(707) 226-9898

317 THIRD STREET, SUITE 1
EUREKA, CA 95501
(707) 269-9595

POST OFFICE BOX 2208
FORT BRAGG, CA 95437
(707) 962-0933

712 MAIN STREET, SUITE 101
WOODLAND, CA 95695
(530) 662-5272

CAPITOL OFFICE:
231 CANNON HOUSE OFFICE BUILDING
WASHINGTON, DC 20515
(202) 225-3311

WEB: <http://mikethompson.house.gov>

October 24, 2008

Dale Morris, Regional Director
Pacific Regional Office
Bureau of Indian Affairs
2800 Cottage Way, Rm. W2820
Sacramento, CA 95825

Re: County of Humboldt
Bear River Casino, Loleta, California

Dear Mr. Morris:

The County of Humboldt, through 1st District Supervisor Jimmy Smith, requested a meeting with BIA representatives to discuss a traffic safety issue at the ingress at Bear River Casino in Humboldt County. The County and residents have proposed traffic control measures in front of the casino, to which the tribe is agreeable. However, at a meeting with a BIA roads department representative in late August, efforts to develop a coordinated approach to solving the traffic safety issue was treated dismissively.

The establishment of the casino in a rural residential area has posed significant traffic safety concerns to the county and to adjacent homeowners. The county's regular planning and permitting processes were not triggered during the initial siting of the facility. Nonetheless, the traffic and safety matters remain and need to be addressed in a coordinated and responsive manner. I would appreciate if you could look into the situation and initiate contact with the County of Humboldt. You may contact Public Works Director Tom Matson at (707) 445-7491 or Supervisor Jimmy Smith at (707) 476-2391.

Thank you for your consideration.

Sincerely,

MIKE THOMPSON
Member of Congress

MT:lm

Humboldt No. 5119

EXHIBIT

5

Bear River Dr.
Lot 2 home
eliminated for
casino sign &
driveway in
photo

Bear River Dr. Lot 1
casino employee
parking lot in photo,
now gas station

Bear River Dr.
Lot 14 home
in photo
eliminated for
relocated new
casino
employee
parking

Bear River Dr. Lot 3
home in photo, now
casino mini-mart

Unimproved shoulder-less Singley Rd. north of casino



Singley Rd. north of casino

Singley Rd. north of casino

blind dip

Casino



NORTH END SINLEY LN
AND SINGLEY RD



Blind corner,
numerous vehicles
failed to negotiate
and ran through
pasture fence

Blumberg No. 9119
EXHIBIT
90

gas station and
off-sale outlet
sign —
inviting
customers to
patronize Casino



Self Serve Gasoline

Regular
Unleaded

185¢

Unleaded

195¢

PUMP & PLAY

Come Join The Fun At
BEAR RIVER CASINO!

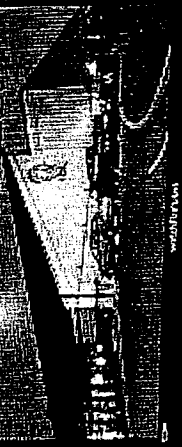

Self Serve Gasoline

**Regular
Unleaded**

**Unleaded
Plus**

**Premium
Unleaded**

Diesel #2

24/7

Close proximity of casino to off-sale
outlet. Separated by 20-30 ft. Bear
River Drive entrance.

EXHIBIT

Blumberg No. 5119

6E

LICENSED PREMISES DIAGRAM (RETAIL)

1. APPLICANT NAME (Last, first, middle) <i>Bear River Casino</i>	2. LICENSE TYPE <i>47</i>
3. PREMISES ADDRESS (Street number and name, city, zip code) <i>11 Bear Paws Way Lodi, CA 95551</i>	4. NEAREST CROSS STREET <i>Singley Road</i>

The diagram below is a true and correct description of the entrances, exits, interior walls and exterior boundaries of the premises to be licensed, including dimensions.

DIAGRAM

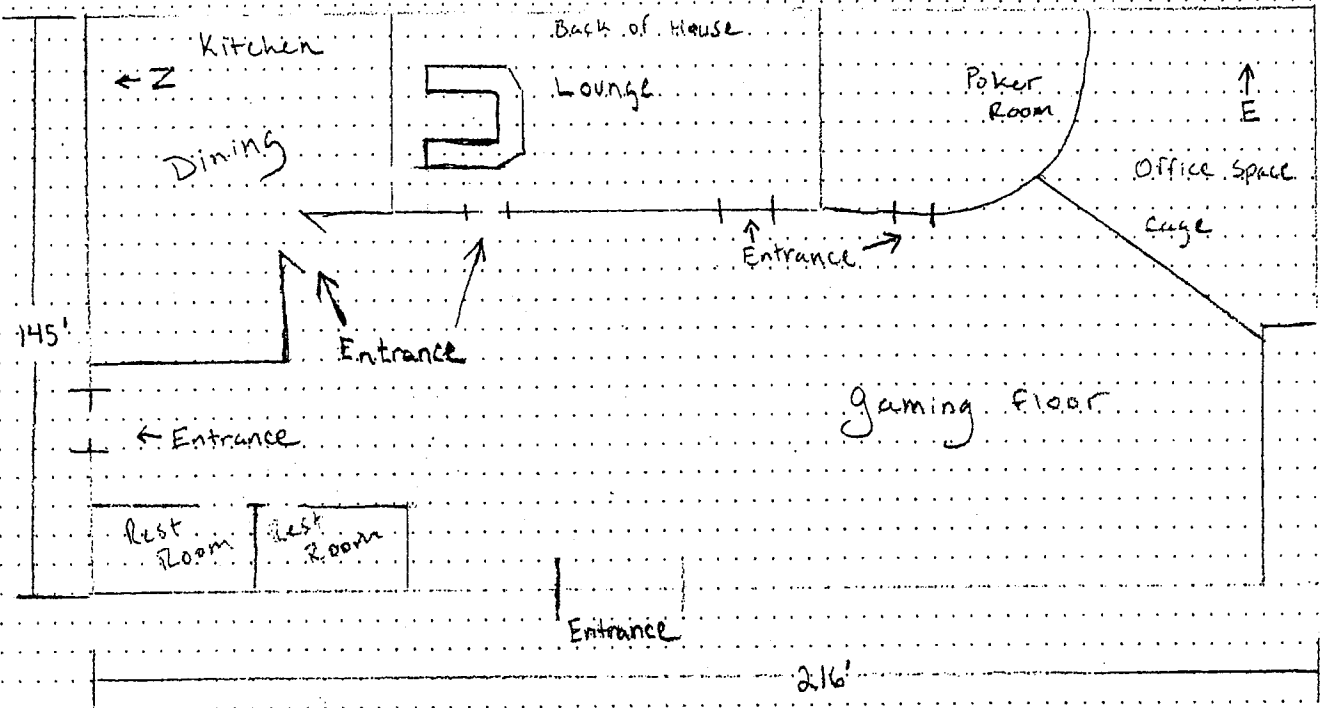

It is hereby declared that the above-described boundaries, entrances and planned operation as indicated on the reverse side, will not be changed without first notifying and securing prior written approval of the Department of Alcoholic Beverage Control. I declare under penalty of perjury that the foregoing is true and correct.

APPLICANT SIGNATURE (Only one signature required) <i>Leonard Bowman</i>	DATE SIGNED <i>2-15-05</i>
FOR ABC USE ONLY	
CERTIFIED CORRECT (Signature)	PRINTED NAME
	INSPECTION DATE

ABC-257 (12/03)



PLANNED OPERATION (RETAIL)

SECTION I - FOR ALL RETAIL APPLICANTS

1. APPLICANT NAME(S) Bear River Casino	2. LICENSE TYPE(S) 47
3. PREMISES ADDRESS (Street number and name, city, zip code) 11 Bear Paws Way Lolo, CA 95551	4. NEAREST CROSS STREET Singley Road

5. TYPE OF BUSINESS (Choose one that best describes the planned operation)

<input checked="" type="checkbox"/> Full Service Restaurant	<input type="checkbox"/> Cafeteria/Hofbrau	<input type="checkbox"/> Cocktail Lounge	<input type="checkbox"/> Private Club
<input type="checkbox"/> Deli or Specialty Restaurant	<input type="checkbox"/> Comedy Club	<input type="checkbox"/> Night Club	<input type="checkbox"/> Veterans Club
<input type="checkbox"/> Cafe/Coffee Shop	<input type="checkbox"/> Brew Pub	<input type="checkbox"/> Tavern	<input type="checkbox"/> Fraternal Club
<input type="checkbox"/> Bed & Breakfast	<input type="checkbox"/> Theater	<input type="checkbox"/> Wine Tasting Room	

<input type="checkbox"/> Supermarket	<input type="checkbox"/> Membership Store	<input type="checkbox"/> Service Station	<input type="checkbox"/> Swap Meet/Flea Market
<input type="checkbox"/> Liquor Store	<input type="checkbox"/> Department Store	<input type="checkbox"/> Convenience Market	<input type="checkbox"/> Drive-in Dairy
<input type="checkbox"/> Variety/Drug Store	<input type="checkbox"/> Gift Shop/Florist	<input type="checkbox"/> Convenience Market w/Gasoline	
<input type="checkbox"/> Other - describe: _____			

6. PATRON CAPACITY 700	7. SURROUNDING AREA <input type="checkbox"/> Commercial <input checked="" type="checkbox"/> Rural <input type="checkbox"/> Residential <input type="checkbox"/> Industrial <input checked="" type="checkbox"/> Other Non-County/Indian Res.	8. PREMISES IS LOCATED IN <input checked="" type="checkbox"/> Free Standing Building <input type="checkbox"/> Shopping Center (Name): _____ <input type="checkbox"/> 10 Units or Less <input type="checkbox"/> More than 10 Units
-------------------------------	--	--

9. FOOD SERVICE <input type="checkbox"/> None <input type="checkbox"/> Minimal <input checked="" type="checkbox"/> Full Meals	10. PARKING LOT? <input checked="" type="checkbox"/> Yes <input type="checkbox"/> No	11. PATIO? <input type="checkbox"/> Yes <input checked="" type="checkbox"/> No	12. WILL YOU HIRE A MANAGER? (Rule 57.5) <input checked="" type="checkbox"/> Yes <input type="checkbox"/> No	13. WILL YOU HAVE A FOOD LESSEE? (Rule 57.7) <input type="checkbox"/> Yes <input checked="" type="checkbox"/> No
--	---	---	---	---

14. MEAL TYPE <input checked="" type="checkbox"/> Dinner House <input checked="" type="checkbox"/> Seafood <input checked="" type="checkbox"/> Fast Food/Deli <input type="checkbox"/> Other: _____ <input checked="" type="checkbox"/> Pizza/Pasta	15. TYPE OF FOOD <input checked="" type="checkbox"/> American <input type="checkbox"/> Greek <input type="checkbox"/> Indian <input type="checkbox"/> French <input type="checkbox"/> Chinese <input type="checkbox"/> Korean <input type="checkbox"/> Italian <input type="checkbox"/> Thai <input type="checkbox"/> Japanese <input checked="" type="checkbox"/> Other: Ethnic/International	16. HOURS OF FOOD SERVICE BREAKFAST HOURS From: 6:00 am To: 11:00 am LUNCH HOURS From: 11:00 am To: 3:00 pm DINNER HOURS From: 3:00 pm To: 6:00 am
--	---	--

17. OPERATING HOURS	Sunday	Monday	Tuesday	Wednesday	Thursday	Friday	Saturday
Opening Time	12:00 pm	12:00 pm	12:00 pm	12:00 pm	12:00 pm	12:00 pm	12:00 pm
Closing Time	12:00 pm	12:00 pm	12:00 pm	12:00 pm	12:00 pm	12:00 pm	12:00 pm

18. ENTERTAINMENT (One or more may apply. Please describe any entertainment with an asterisk (*) below)

<input type="checkbox"/> None	<input checked="" type="checkbox"/> *Amplified Music	<input type="checkbox"/> Patron Dancing	<input checked="" type="checkbox"/> Card Room
<input checked="" type="checkbox"/> Recorded Music	<input checked="" type="checkbox"/> *Live Entertainment	<input type="checkbox"/> Bikini/Topless/Exotic	<input type="checkbox"/> Movies
<input type="checkbox"/> Juke Box	<input checked="" type="checkbox"/> *Floor/Stage Shows	<input type="checkbox"/> Pool/Billiard Tables	<input type="checkbox"/> "Hot Spot"/Lottery
<input type="checkbox"/> *Other	<input checked="" type="checkbox"/> Karaoke	<input type="checkbox"/> *Amateur/Pro Sports Events	<input checked="" type="checkbox"/> Video/Coin-Operated Games

*Description: _____

19. PREMISES IS LOCATED ON <input type="checkbox"/> Major Thoroughfare <input type="checkbox"/> Secondary Street <input checked="" type="checkbox"/> Other	20. TYPE OF STRUCTURE <input checked="" type="checkbox"/> Single Story <input type="checkbox"/> Two-Story <input type="checkbox"/> Multi-Story - Number of stories: _____
--	---

21. PASS-THROUGH WINDOW? <input type="checkbox"/> Yes <input checked="" type="checkbox"/> No	22. FIXED BARS? <input checked="" type="checkbox"/> Yes - how many: 1 <input type="checkbox"/> No	23. WHAT PERCENTAGE OF YOUR TOTAL SALES WILL BE ALCOHOLIC BEVERAGES? 3%
---	--	--

FOR ABC USE ONLY

24. INFORMATION GIVEN (R-27, R-107, Sec. 25612.5, Sec. 23790.5, etc.)	25. DATE ENTERED INTO CABIN
---	-----------------------------

Instructions to Applicant:

Draw a sketch of the area on which the licensed premises is or will be located. Show adjacent structures and nearest cross streets. If this is an event for a daily license, catering authorization or miscellaneous use, show the area where sales and consumption of alcoholic beverages will occur. Post a copy of this diagram with Daily License, Catering Authorization or Event Authorization where the event is held. Sales and consumption of alcoholic beverages must be confined to the area designated in the diagram and supervised to prevent violations of the Alcoholic Beverage Control Act.

1. APPLICANT NAME (Last, first, middle) <i>Bear River Casino</i>	2. LICENSE TYPE <i>47</i>
3. PREMISES ADDRESS (Street number and name, city, zip code) <i>11 Bear Paws Way Loleta, CA 95551</i>	4. NEAREST CROSS STREET <i>Singley Road</i>

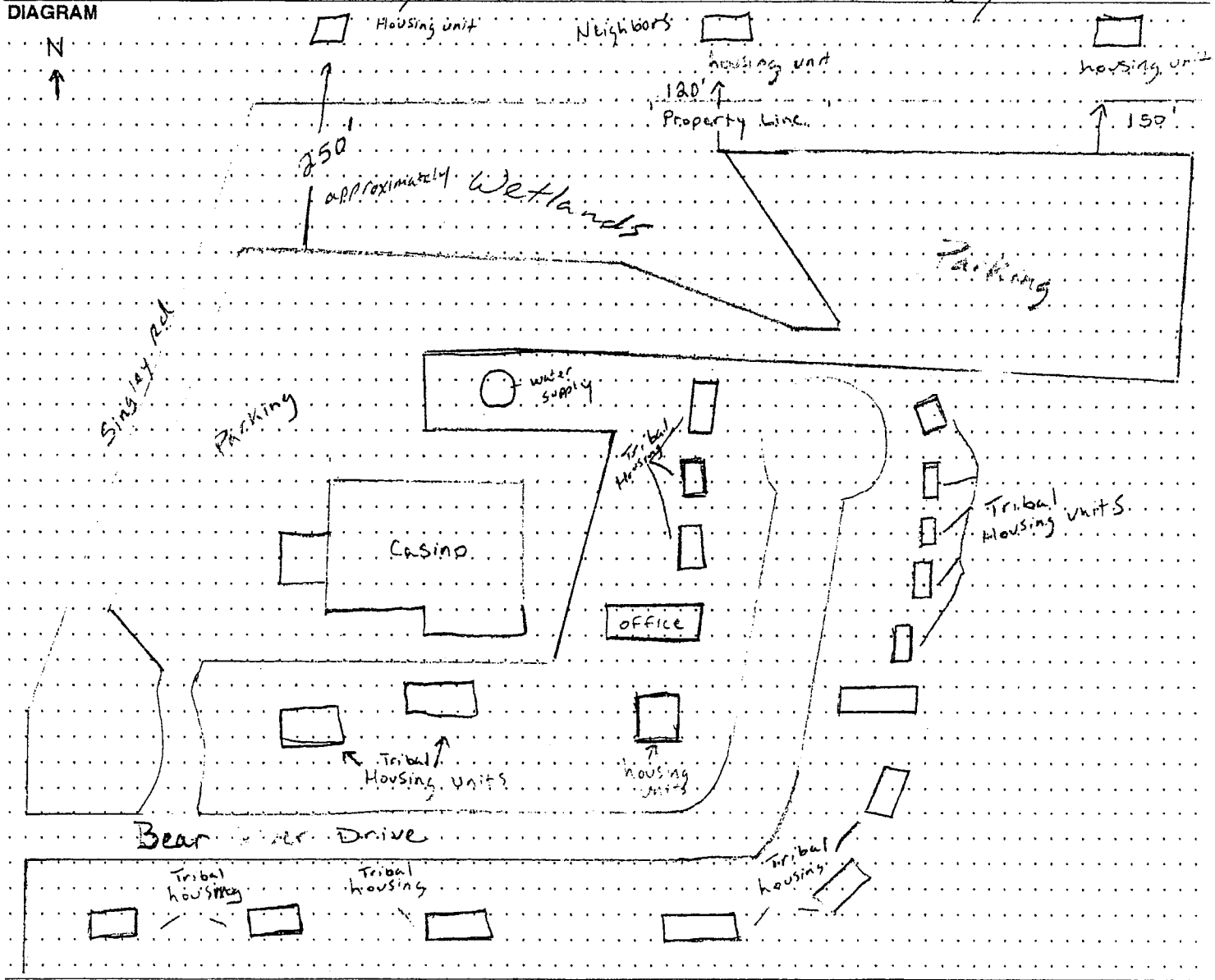

I have read the above instructions and I declare under penalty of perjury that the above diagram is true and correct.

APPLICANT SIGNATURE <i>Leonard Bowman</i>	DATE SIGNED <i>2-15-05</i>
--	-------------------------------

FOR ABC USE ONLY

CERTIFIED CORRECT (Signature)	PRINTED NAME	INSPECTION DATE
-------------------------------	--------------	-----------------

LICENSED PREMISES DIAGRAM (RETAIL)

1. APPLICANT NAME (If individual: Last, first, middle) BEAR RIVER CASINO (95551)	2. LICENSE TYPE 20
3. PREMISES ADDRESS (Street number and name, city, zip code) 10 BEAR RIVER DRIVE, COLTON CA	4. NEAREST CROSS STREET SINGLEY ROAD

The diagram below is a true and correct description of the entrances, exits, interior walls and exterior boundaries of the premises to be licensed, including dimensions and identification of each room (i.e., "storeroom", "office", etc.).

DIAGRAM *See attached diagram floor plan*

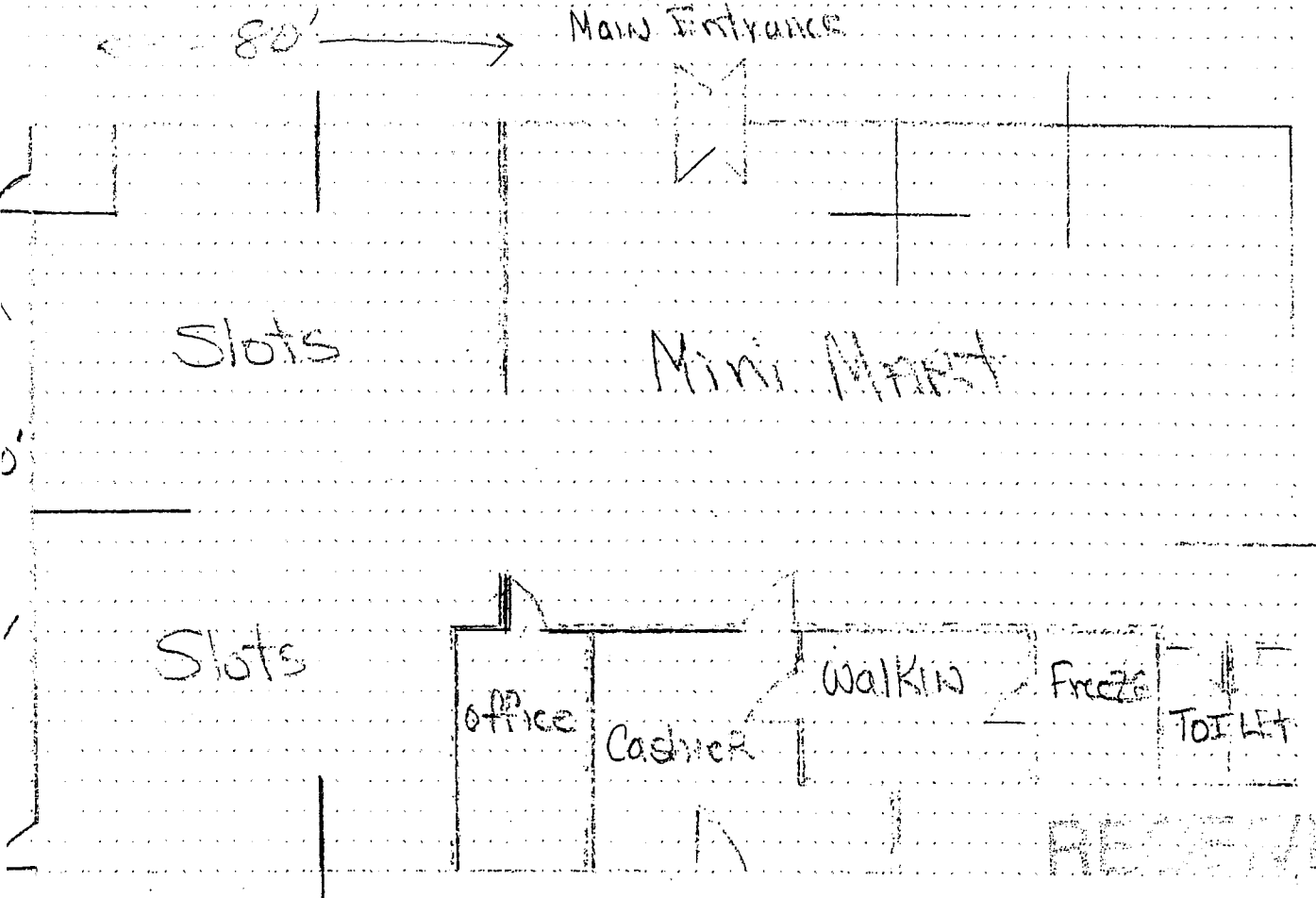

JUN 20 2008

Alcoholic Beverage Control
CALIFORNIA DISTRICT

It is hereby declared that the above-described boundaries, entrances and planned operation as indicated on the reverse side, will not be changed without first notifying and securing prior written approval of the Department of Alcoholic Beverage Control. I declare under penalty of perjury that the foregoing is true and correct.

APPLICANT SIGNATURE (Only one signature required) <i>Leonard ...</i>	DATE SIGNED 6-17-08
FOR ABC USE ONLY	
CERTIFIED CORRECT (Signature)	PRINTED NAME
	INSPECTION DATE 7-3-08



January 30, 2006

Mr. Bruce Merson
 Bear River Band of the Rohnerville Rancheria
 27 Bear River Drive
 Loleta, CA 95551

Re: Singley Road Intersection Design

Dear Bruce:

The purpose of this letter is to summarize the analysis completed by Winzler & Kelly for the layout of an intersection at the location of Singley Road and Bear River Road. The preliminary design is based on the design standards listed below. We offer the following design explanations and included exhibits for your consideration of the intersection layout we have proposed.

Design Standards

1994 AASHTO
 Caltrans Highway Design Manual
 2000 Highway Capacity Manual

ADT	Over 400	(estimated)
Design Speed	30 mph	(per County)
Lane width	11 feet	(per AASHTO)
Shoulder width	4 feet	(per AASHTO)

Site Distance (using 50km/hr or 30mph design speed – rounded to be conservative)

Stopping	220 feet	(CALTRANS)
Corner	360 feet	(CALTRANS)

1) Intersection Geometrics

The proposed intersection connecting the proposed development west of Singley Road and the existing Bear River Casino gaming facility is shown in Exhibit A included with this letter. The layout for this new intersection has been created with the assistance of Autoturn software which allows use of various vehicular turning templates to evaluate turn movements. For the proposed development of the property west of the intersection, it is anticipated that there will be passenger vehicles, recreational vehicles, and large commercial trucks using the roadway including diesel

Bruce Merson
Bear River Band of the Rohnerville Rancheria
January 30, 2006
Page 2

delivery trucks. The Caltrans 65' semi-trailer turning template (California Design Vehicle) was conservatively used in the layout to ensure that tractor-trailers and diesel deliver trucks could negotiate the entrance and access the site.

The entrance for the proposed development is shown perpendicular to the roadway and has been designed as a 3-way stop intersection with a thru movement north uphill along Singley Road as shown on Exhibit A. This was done for two reasons. The intersection design is dominated by the larger vehicle turning patterns and it is important due to the grade that large trucks do not have to stop on the steep approach. In addition the predicted traffic conditions and volumes do not warrant a left turn pocket for the uphill traffic movement.

The intersection will have stop bars, stop signs, lane striping, and warning signs along each approaching leg as shown in Exhibit B Signage and Striping Plan.

2) Vertical Alignment / Site Distance

The vertical alignment is unchanged and matches the existing alignment. Existing access and slope constraints do not justify modifying the existing vertical alignment.

The proposed Singley Road Intersection location was evaluated for both stopping site distance and corner site distance requirements per the per the Caltrans Highway Design manual standards for two lane at-grade intersections. Using a 30 mph design speed, 220 feet are required for the reaction and braking time to stop a vehicle, as shown in Exhibit C. In addition, based on the referenced standards, there is a certain sight distance, or corner site distance, required between a vehicle waiting to cross the intersection and the driver of the approaching vehicle. For the proposed intersection, and using a design speed of 30 mph, 360 feet of corner site distance is required. Thus, for both of these requirements, the limits fall on the south end of the vertical curve crest and along a constant slope down to the new intersection.

To verify that the stopping site distance would be adequate to provide safety for vehicles crossing the intersection, a 40 mph design speed was assumed (10 mph over the posted speed limit). Based on Caltrans standards, vehicles require approximately 310 feet to safely stop the vehicle in time for the intersection. This distance falls on the south end of the vertical curve crest shown north of the intersection on Exhibit C. This verifies that the vertical alignment north of the proposed intersection is adequate and should not have to be modified.

C:\pwworkspace\AutoCAD\Projects\178\178.dwg 1/78/2006

EXHIBIT A - INTERSECTION LAYOUT

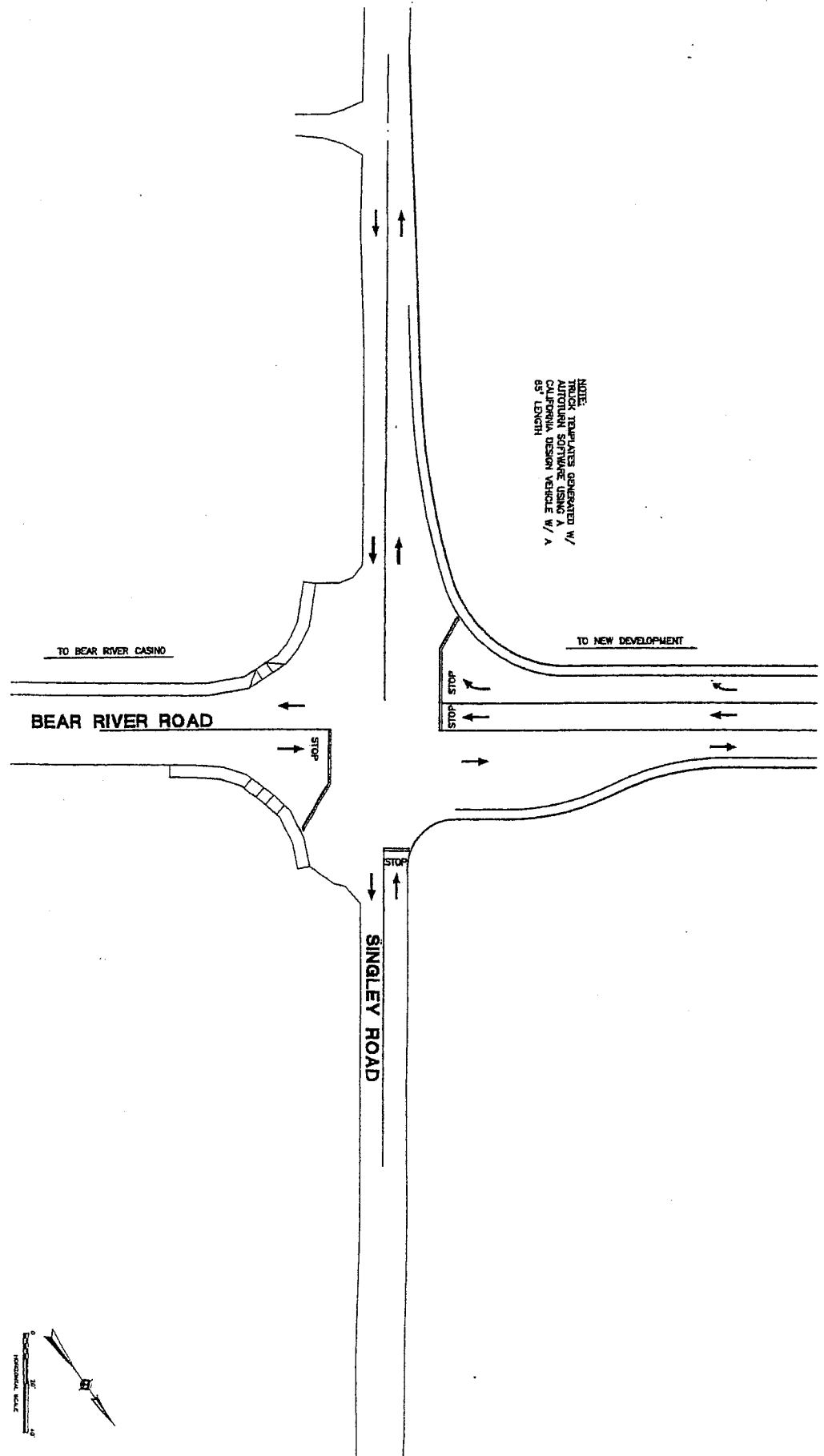

NOTE:
 TRAFFIC SIGNALS GENERATED W/
 AUTOMATIC SIGNALS AT INTERSECTION
 CALIFORNIA DESIGN VEHICLE W/ A
 65' LENGTH

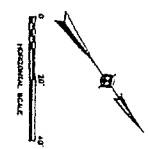

EX-A	PROJECT NO.	01568081001
	DATE	1 0 3
	BEAR RIVER BAND SINGLEY ROAD INTERSECTION DESIGN	
	CIVIL EXHIBIT A INTERSECTION LAYOUT	

DESIGNED BY	J.S.	CHECKED BY	J.S.
DRAWN BY	A.C.	SCALE	AS NOTED

WINZLER KELLY
 CONSULTING ENGINEERS
 833 THIRD STREET
 EMERYVALE, CA 94601-0417
 PH (707) 443-8336
 FAX (707) 444-8330

DATE	DESCRIPTION	BY

EXHIBIT B - SIGNAGE & STRIPING PLAN

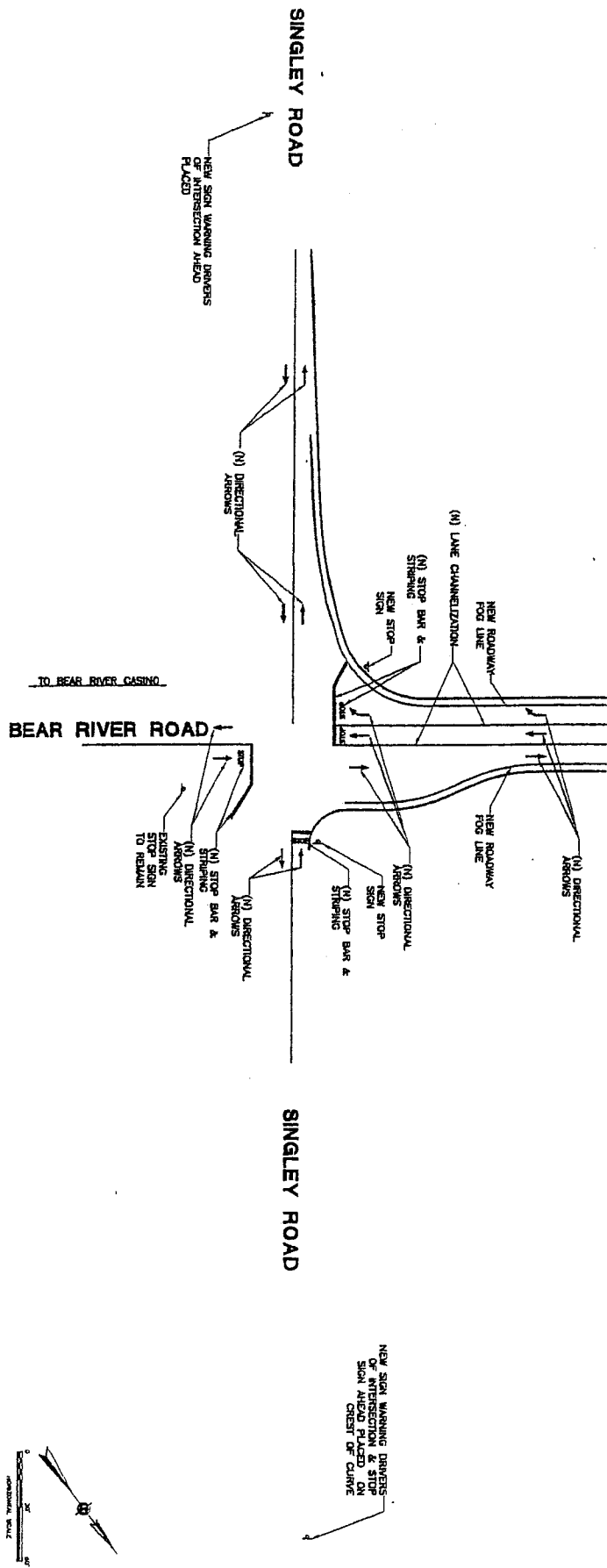

LA COUNTY, CALIFORNIA, DEPARTMENT OF PUBLIC WORKS, DIVISION OF TRANSPORTATION, 1/24/2008

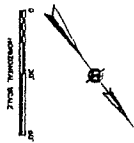

BEAR RIVER BAND	
SINGLEY ROAD	
INTERSECTION DESIGN	
CIVIL	
EXHIBIT B	
SIGNAGE & STRIPING PLAN	
DATE	1/24/08
BY	JAC
CHKD	JAC
APP'D	

DRAWING SCALE	
AS NOTED	

WINZLER KELLY
CONSULTING ENGINEERS
633 THIRD STREET
DUNEDIN, CA 95001-0417
PH (925) 441-4332
FAX (925) 441-4330

NO.	DATE	DESCRIPTION

EX-B

1/28/2018

EXHIBIT A - INTERSECTION LAYOUT

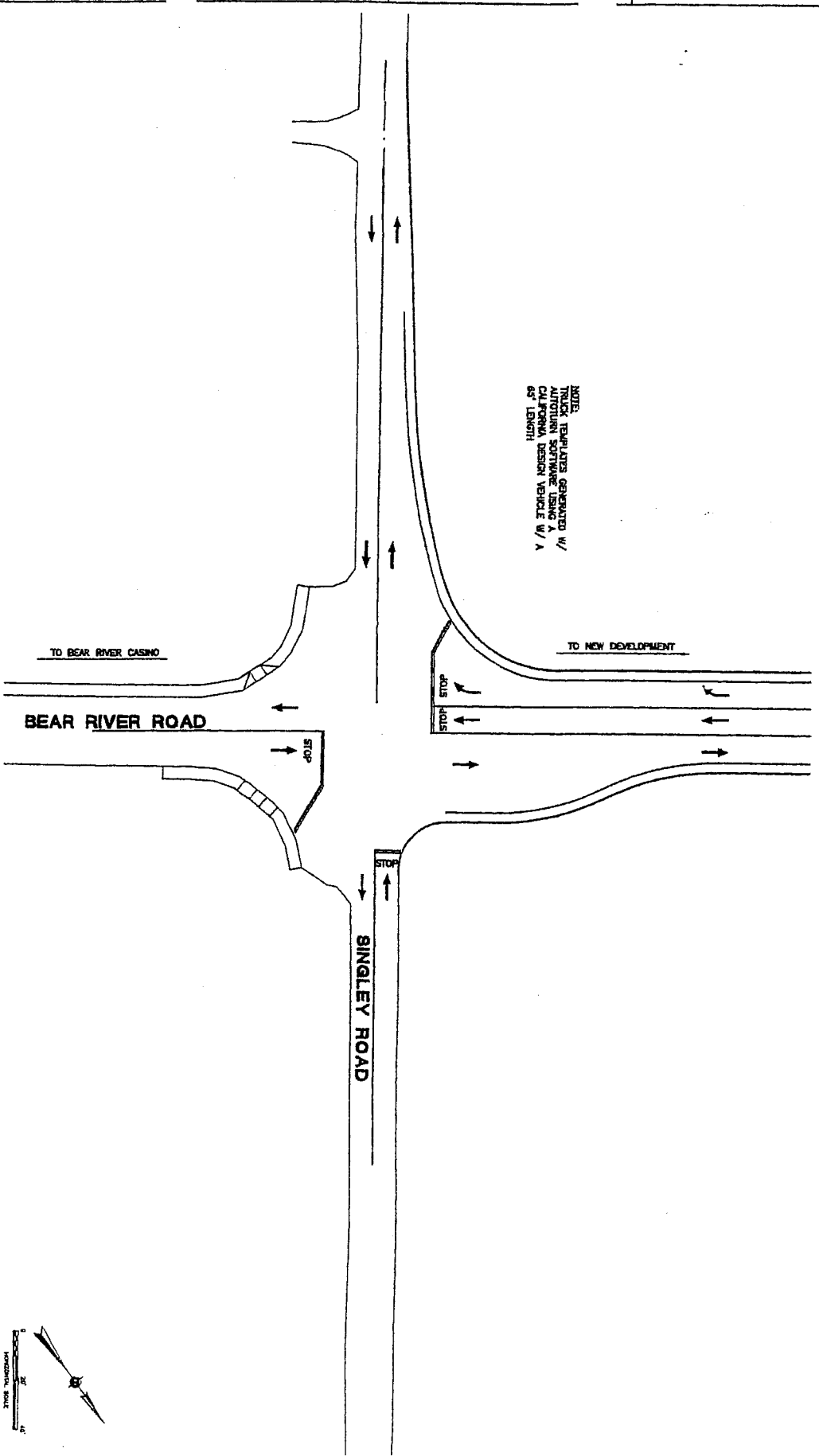

NOTE:
TRUCK TEMPLATE GENERATED W/
AUTUMN SOFTWARE USING A
CALIFORNIA DESIGN VEHICLE W/ A
35' LENGTH

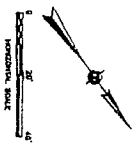

BEAR RIVER BAND
SINGLEY ROAD
INTERSECTION DESIGN
CIVIL
EXHIBIT A
INTERSECTION LAYOUT

DRAWING SCALE
AS NOTED

WINZLER KELLY
CONSULTING ENGINEERS
433 THIRD STREET
BURDICK, CA 95501-0417
PH (707) 443-8332
FAX (707) 444-8336

NO.	DATE	DESCRIPTION

EX-A

BEAR RIVER BAND SINGLEY ROAD INTERSECTION DESIGN CIVIL EXHIBIT C PLAN & PROFILE		DRAWING SCALE AS NOTED
WINZLER & KELLY ENGINEERS ARCHITECTS 633 THIRD STREET LINDSEY, CA 95021-0117 FAX (707) 444-4338 PHONE (707) 444-8220	SHEET NO. 3 OF 5	PROJECT NO. 0150000001 DATE 1/28/2008

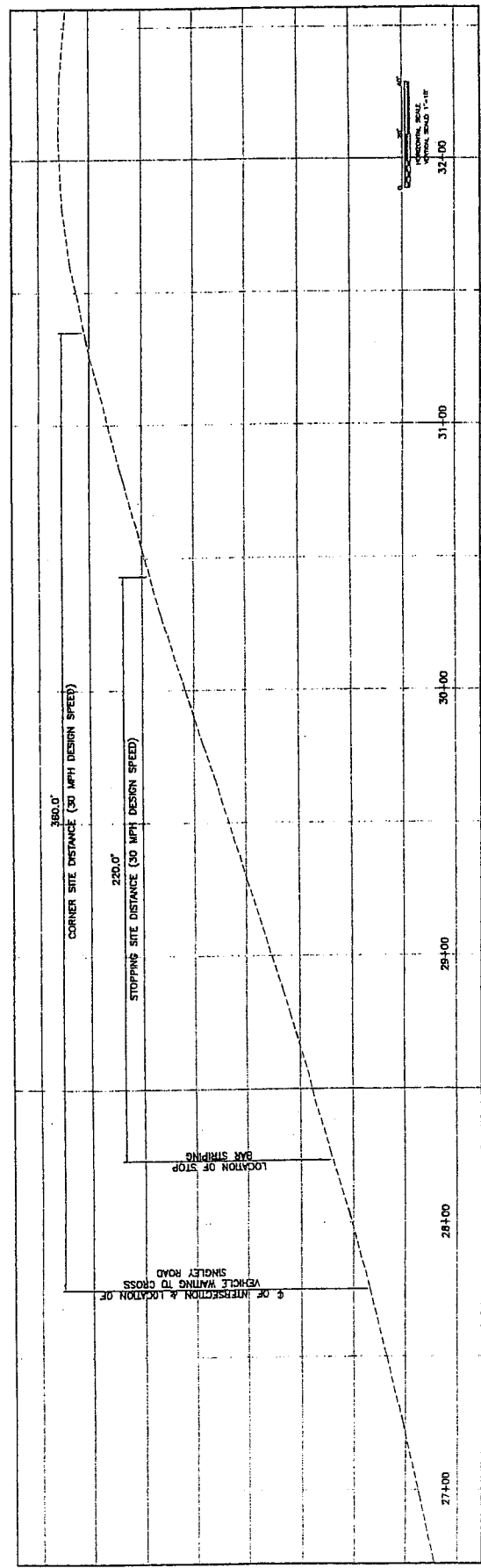
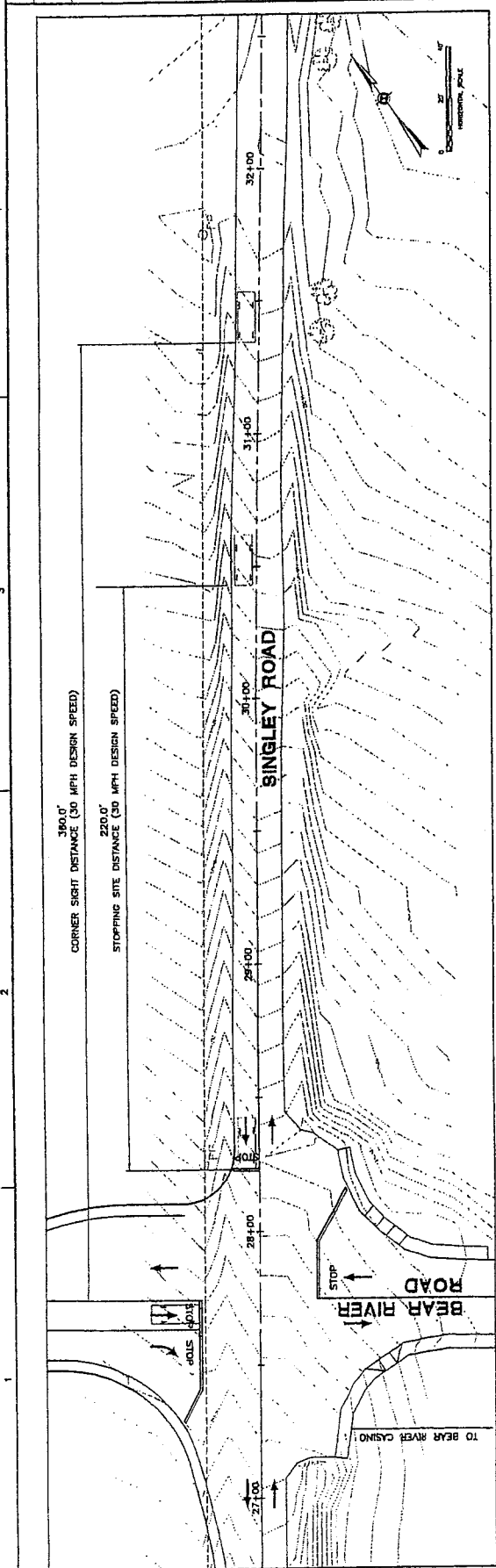
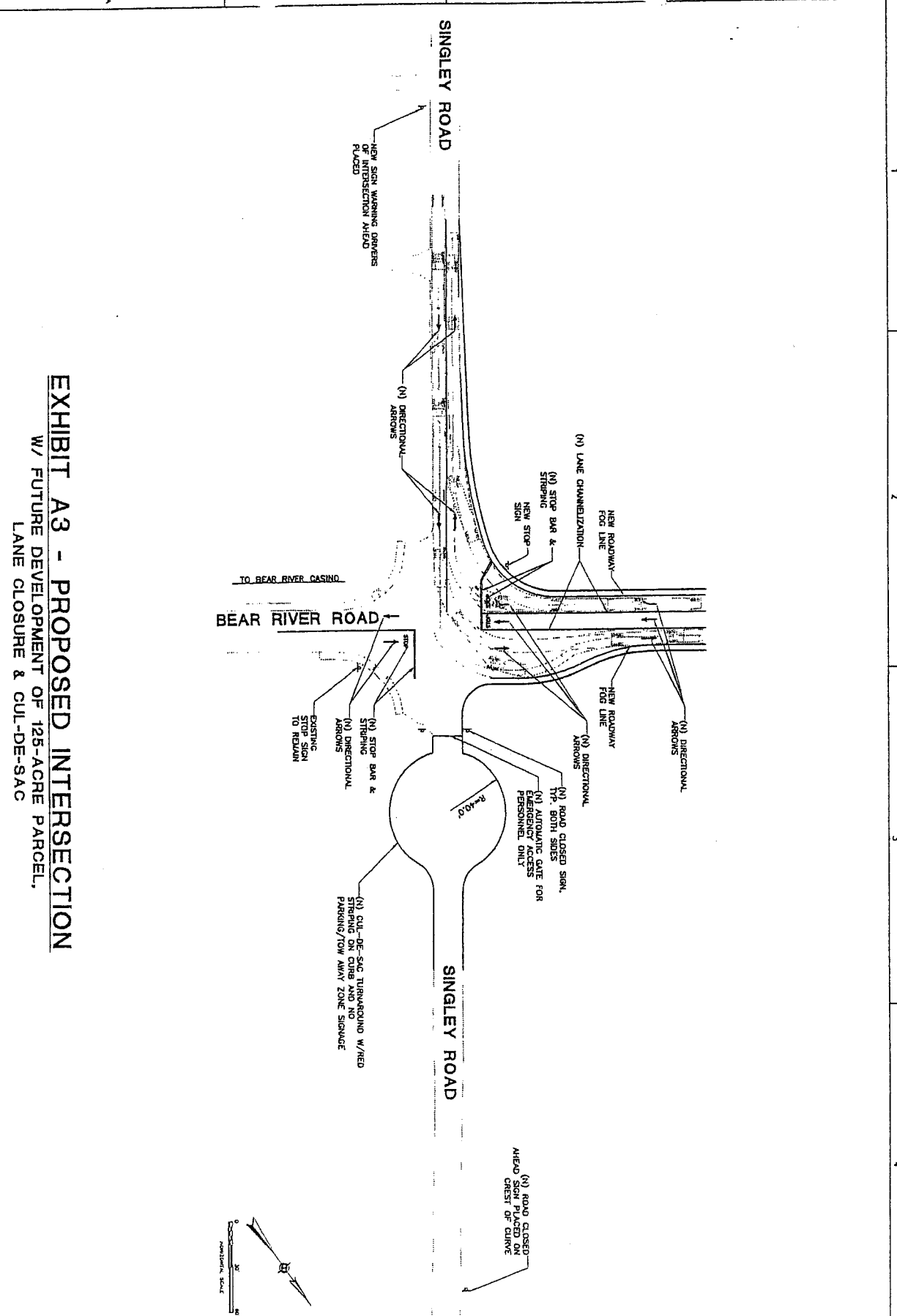

EXHIBIT C - PLAN & PROFILE



1. C:\Users\jv\OneDrive\Documents\101388066\101388066.dwg - Singley Road Intersection Design Plan.dwg

EXHIBIT A3 - PROPOSED INTERSECTION
W/ FUTURE DEVELOPMENT OF 125-ACRE PARCEL,
LANE CLOSURE & CUL-DE-SAC

BEAR RIVER BAND	
SINGLEY ROAD	
INTERSECTION DESIGN	
CIVIL	
EXHIBIT A3	
DATE	01/28/2016
BY	JVC
APP	
CHK	
EX-A	

CD	JS	SP	SS
APP	AJC	DR	SSM
DRAWING SCALE			

WINZLER KELLY
 CONSULTING ENGINEERS
 833 THIRD STREET
 EUREKA, CA 95501-0417
 PH (707) 442-8374
 FAX (707) 444-8350

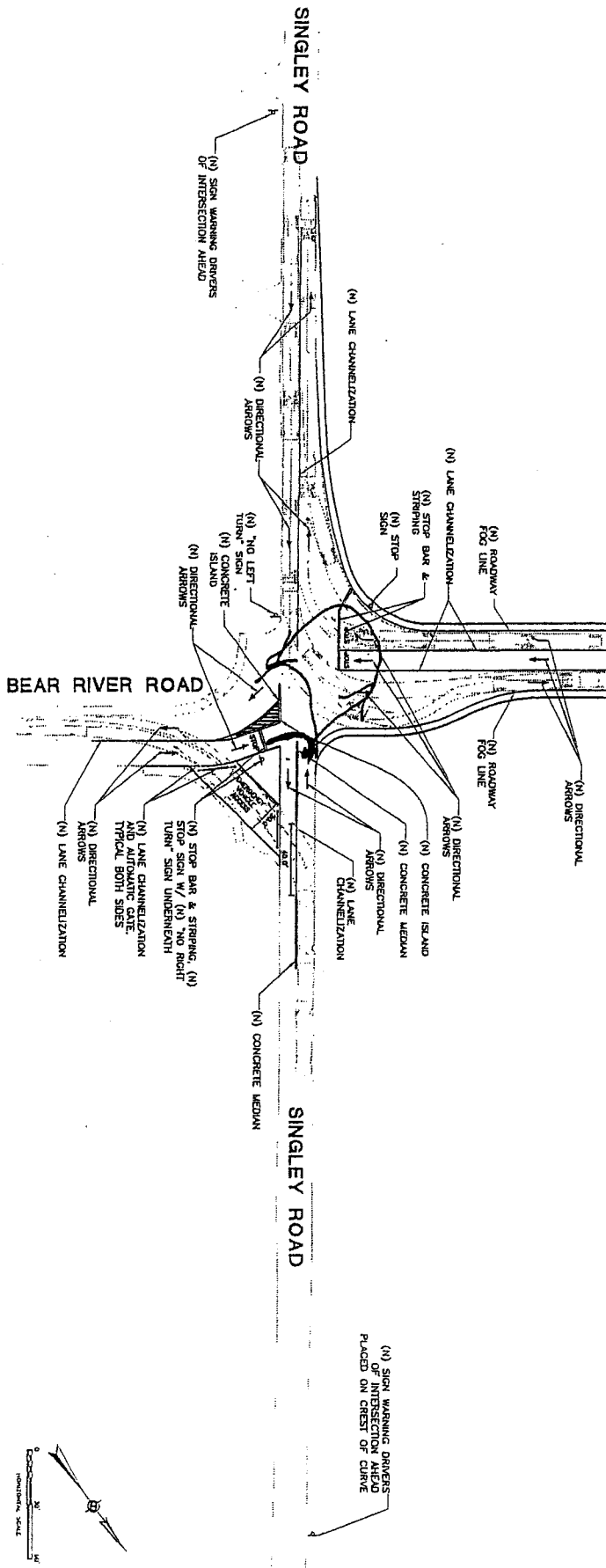
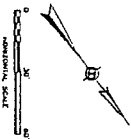
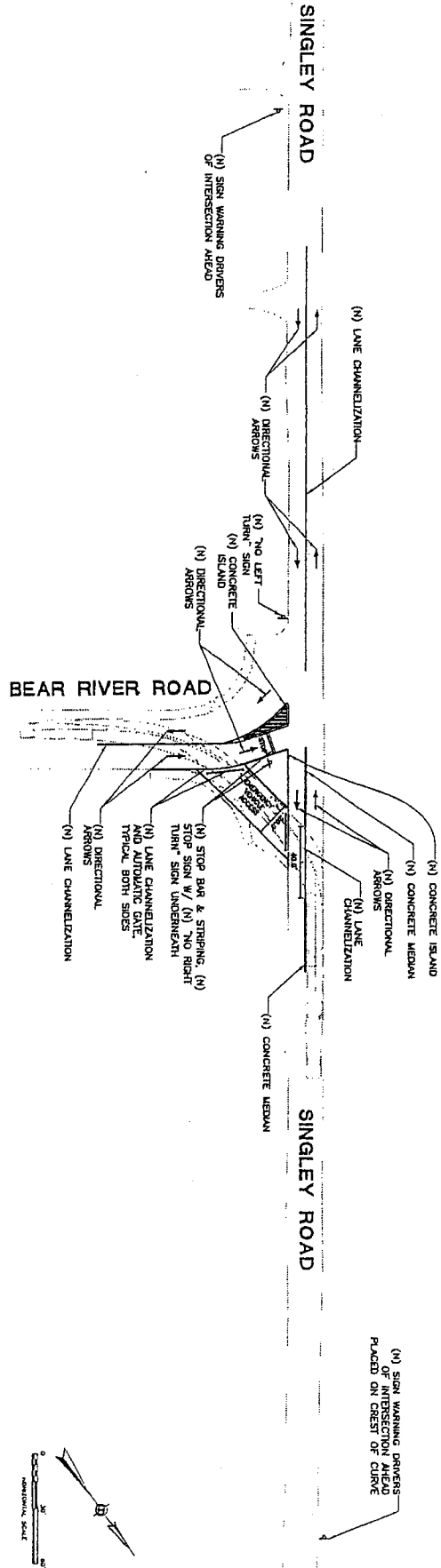

**EXHIBIT B - PROPOSED INTERSECTION
W/ FUTURE DEVELOPMENT OF 125-ACRE PARCEL
& INTERSECTION OFFSET**

3:\CA\0951\2096\015896001\Map\Y-06-06_Singley Road Intersection Design_Plan\Civil Base.dwg 9/9/2006

BEAR RIVER BAND SINGLEY ROAD INTERSECTION DESIGN CIVIL EXHIBIT B	DATE: 01/28/2006 DRAWN BY:	CHECKED BY:	DESIGNED BY:	APPROVED BY:	WINZLER KELLY CONSULTING ENGINEERS 833 THIRD STREET EUREKA, CA 95501-0417 PHONE (707) 444-8338 FAX (707) 444-8330	SHEET NO.:	TOTAL SHEETS:
	EX-B	DRAWING SCALE AS NOTED	SURVEILLANT:	DATE:	PROJECT NO.:	SCALE:	DATE:

EXHIBIT 1 - PROPOSED INTERSECTION



C:\Program Files\AutoCAD\Plot\Plot1.dwg (1:1) - 08, Singley Road Intersection Design Plan, Exhibit 1.dwg 7/24/2006

BEAR RIVER BAND SINGLEY ROAD INTERSECTION DESIGN CIVIL EXHIBIT 1 PROPOSED INTERSECTION	DATE: 01/25/2006 TIME: 10:00 AM	DRAWING SCALE AS NOTED	WINZLER & KELLY CONSULTING ENGINEERS 633 THIRD STREET DUNELAK, CA 92501-0117 PH (907) 443-8326 FAX (907) 441-8330	NO. _____ REV. _____ DATE _____ BY _____ CHECKED _____ APPROVED _____
	EX-1	PROJECT NO. _____ SHEET NO. _____	DATE: _____ TIME: _____	PROJECT NAME: _____ CLIENT: _____

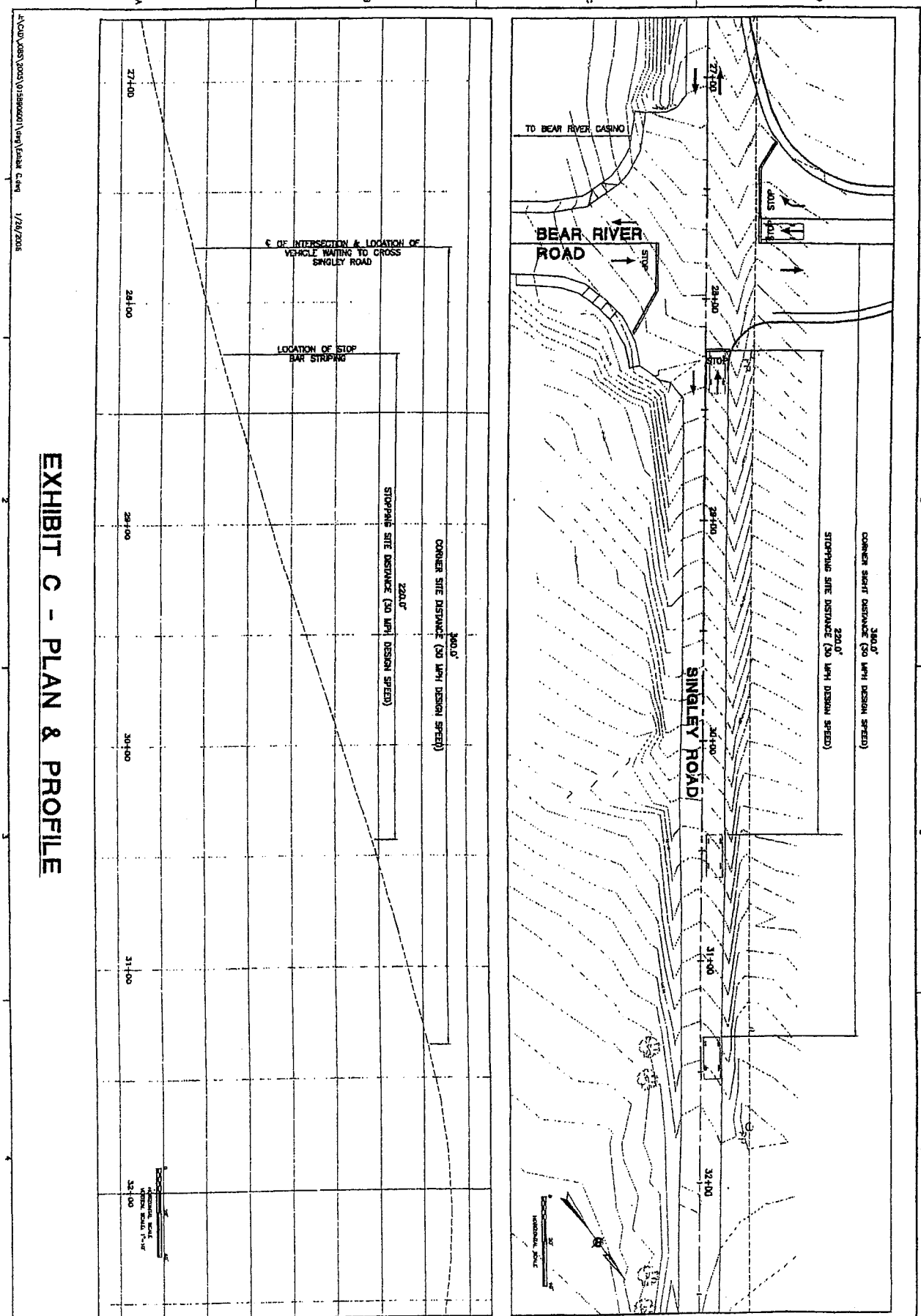

EXHIBIT C - PLAN & PROFILE

1:5000 (GROSS) (2005) (1:15000) (1/28/2008)

BEAR RIVER BAND SINGLEY ROAD INTERSECTION DESIGN CIVIL EXHIBIT C DRAWING SCALE AS NOTED	WINZLER & KELLY CONSULTING ENGINEERS 833 THIRD STREET EMERYVILLE, CA 94607-0417 PH (925) 443-8330 FAX (925) 444-9330	DATE: 01/28/2008
		DRAWING NO: EX-C



IN REPLY REFER TO:

United States Department of the Interior

BUREAU OF INDIAN AFFAIRS
Pacific Regional Office
2800 Cottage Way
Sacramento, California 95825

DEC 12 2008

Honorable Mike Thompson, Congressman
1st District, California
317 Third Street, Suite I
Eureka, California 95501

Dear Mr. Thompson:

This is in response to your letter dated October 24, 2008 in regard to the Bear River Casino Access Road. A meeting was held on August 21, 2008 by my staff with the Tribal Council, Tribal staff; County Supervisor, Jimmy Smith and County Engineer, Bob Bronkall to discuss issues related to vehicle traffic on Singley Road (owned by the County) east of Bear River Casino Access Road. In the meeting the following issues were discussed:

1. Improvement of the intersection of Singley Road and the Bear River Casino Access Road to improve safety and mitigate the traffic problem.
2. Since the County indicated that the vehicle traffic on Singley Road, east of the Casino has increased due to the Casino, we requested the County to conduct a Traffic Count to determine whether or not there has been any traffic increase on Singley Road due to the Casino beyond the Casino on the east side of Singley Road. In the meeting, the County had agreed to perform a Traffic Study. We have received the Traffic Count data indicating no traffic increase on Singley Road east of the Casino. Therefore, there is no need for any action to be taken by either the Tribe or the BIA.

Based on information available from the Tribe, it is our understanding that;

(a) The Tribe has developed plans for improvement of the intersection of Bear River Drive and Singley Road to improve traffic flow and the safety of motorist on Singley Road as well as Bear River Drive.

TAKE PRIDE
IN AMERICA 

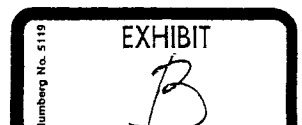

(b) The intersection plans were reviewed and approved/concurred by the County for the improvement of the intersection.

(c) The Tribe plans to improve the intersection as soon as possible.

In addition to improvement of the intersection (South side) of the Bear River Casino Access Road and Singley Road, the BIA plans to improve the intersection of Singley Road and Bernard Road (North side) to improve the safety of motorist at the intersection. *Brenad*

If you have any questions or need further information, please contact Kanu Patel, Regional Roads Engineer, at (916) 978-6033.

Sincerely,

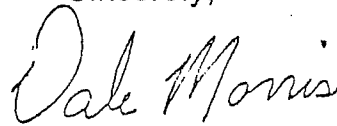
A handwritten signature in cursive script that reads "Dale Morris".

Regional Director

cc: Rohnerville Tribal Chairman,
Civil Engineering Technician, NCA