

**Attachment A: SR 99/Mingo Road Interchange
Conceptual Design Options**

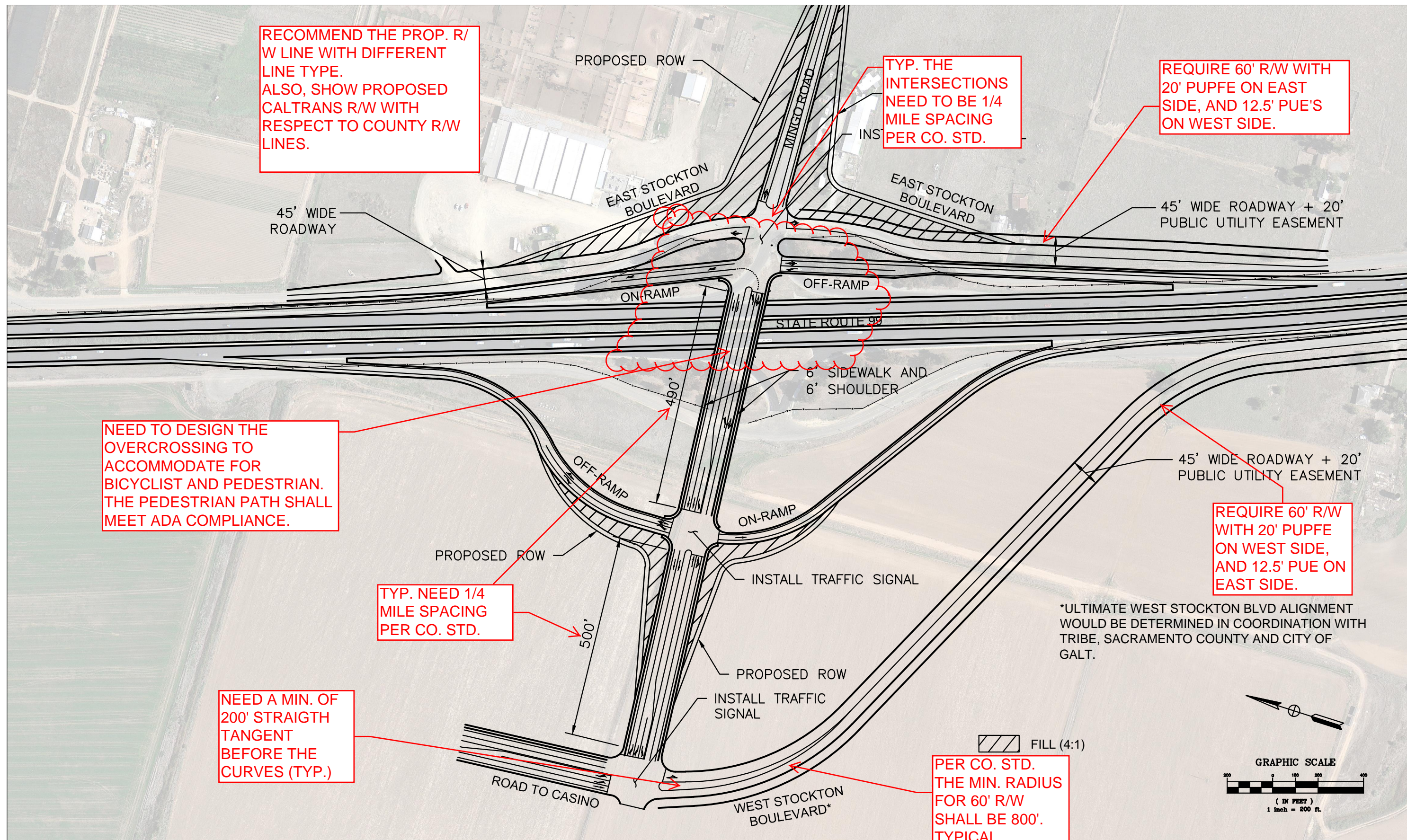

RECOMMEND THE PROP. R/W LINE WITH DIFFERENT LINE TYPE. ALSO, SHOW PROPOSED CALTRANS R/W WITH RESPECT TO COUNTY R/W LINES.

TYP. THE INTERSECTIONS NEED TO BE 1/4 MILE SPACING PER CO. STD.

REQUIRE 60' R/W WITH 20' PUPFE ON EAST SIDE, AND 12.5' PUE'S ON WEST SIDE.

NEED TO DESIGN THE OVERCROSSING TO ACCOMMODATE FOR BICYCLIST AND PEDESTRIAN. THE PEDESTRIAN PATH SHALL MEET ADA COMPLIANCE.

TYP. NEED 1/4 MILE SPACING PER CO. STD.

REQUIRE 60' R/W WITH 20' PUPFE ON WEST SIDE, AND 12.5' PUE ON EAST SIDE.

NEED A MIN. OF 200' STRAIGHT TANGENT BEFORE THE CURVES (TYP.)

PER CO. STD. THE MIN. RADIUS FOR 60' R/W SHALL BE 800'. TYPICAL.

*ULTIMATE WEST STOCKTON BLVD ALIGNMENT WOULD BE DETERMINED IN COORDINATION WITH TRIBE, SACRAMENTO COUNTY AND CITY OF GALT.

SR-99/MINGO ROAD INTERCHANGE - OPTION 1

JUNE 10th, 2015
KHA JOB # 092373003



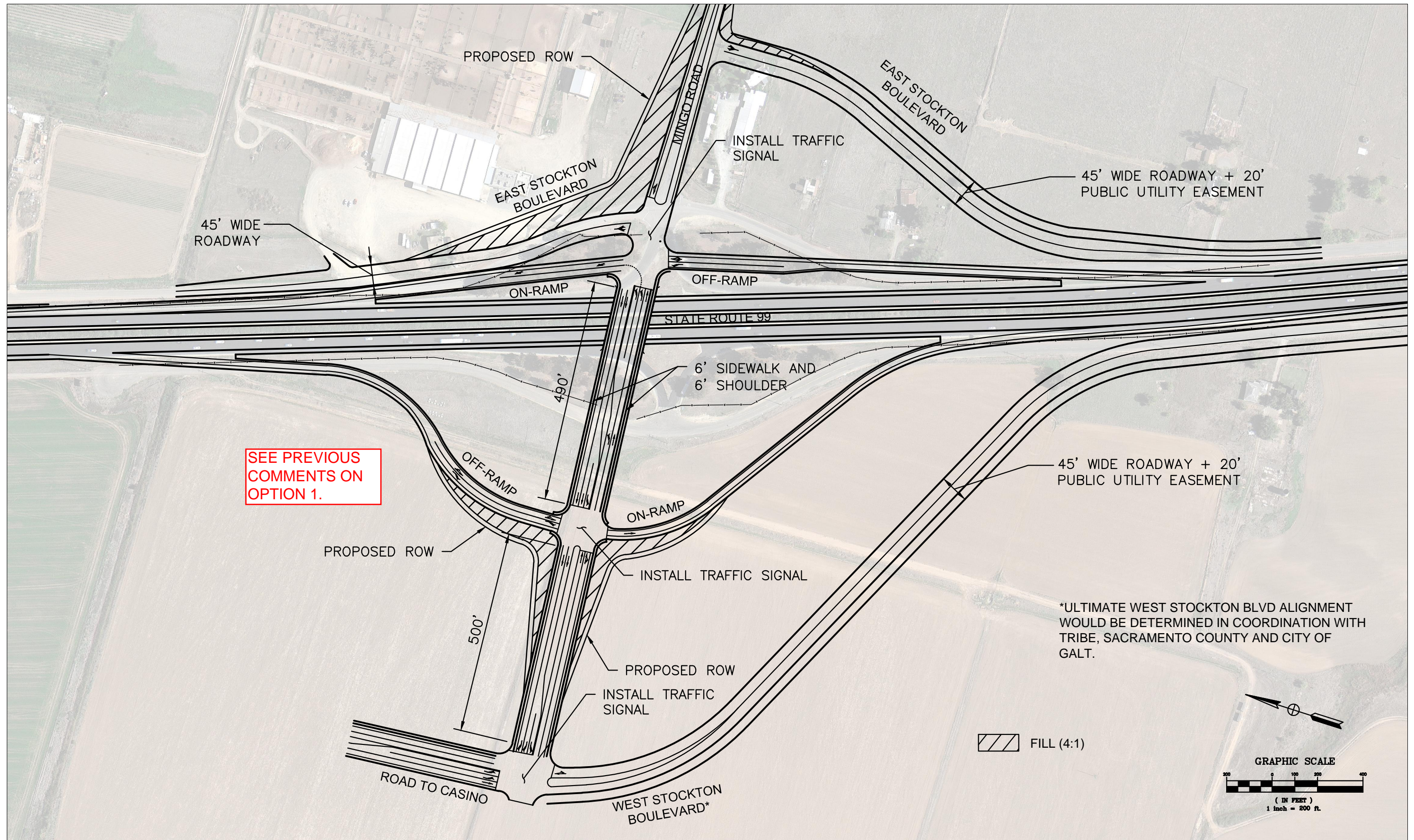

SEE PREVIOUS
COMMENTS ON
OPTION 1.

SR-99/MINGO ROAD INTERCHANGE - OPTION 2

JUNE 10th, 2015
KHA JOB # 092373003

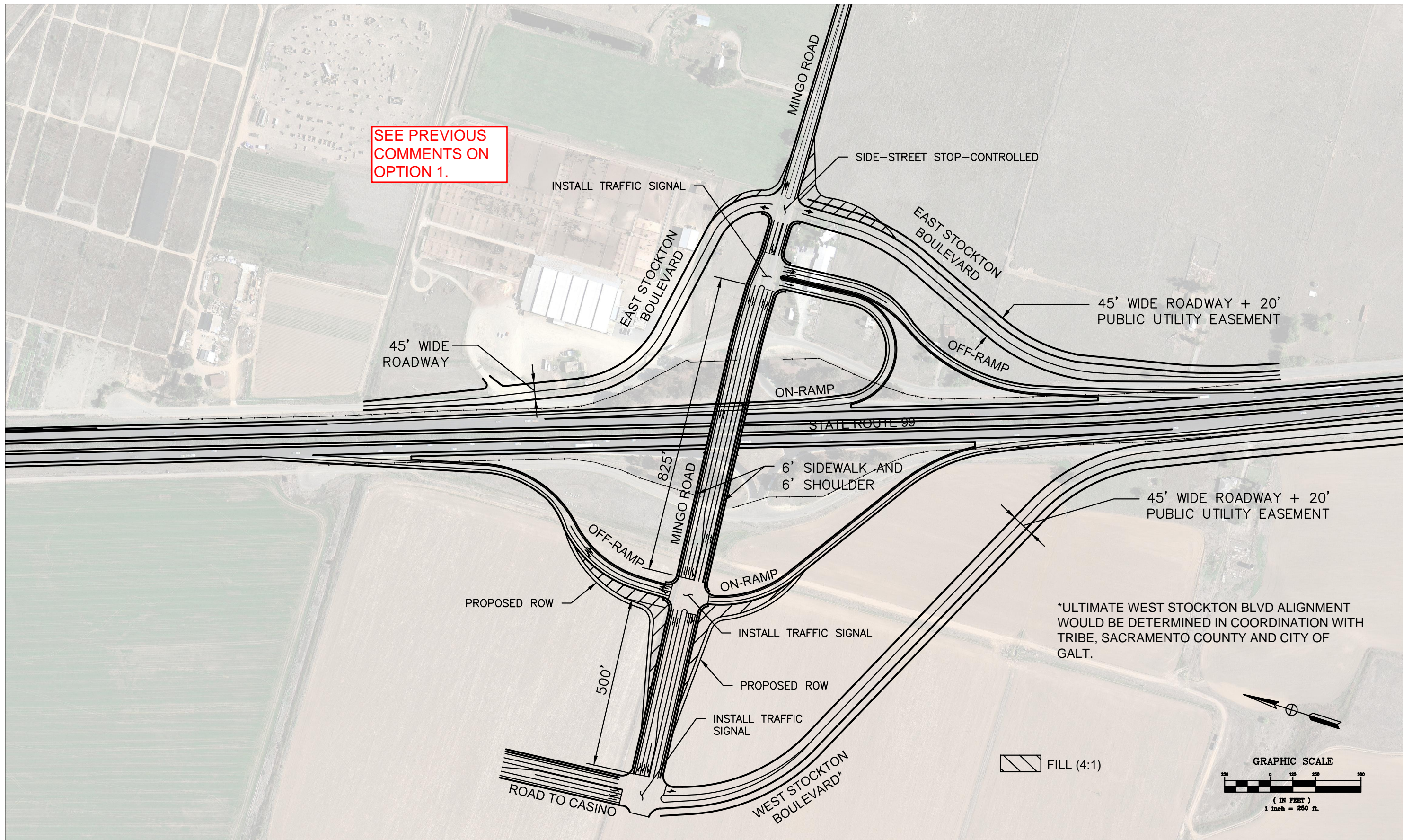

SEE PREVIOUS COMMENTS ON OPTION 1.

SR-99/MINGO ROAD INTERCHANGE - OPTION 3

JUNE 10th, 2015
KHA JOB # 092373003

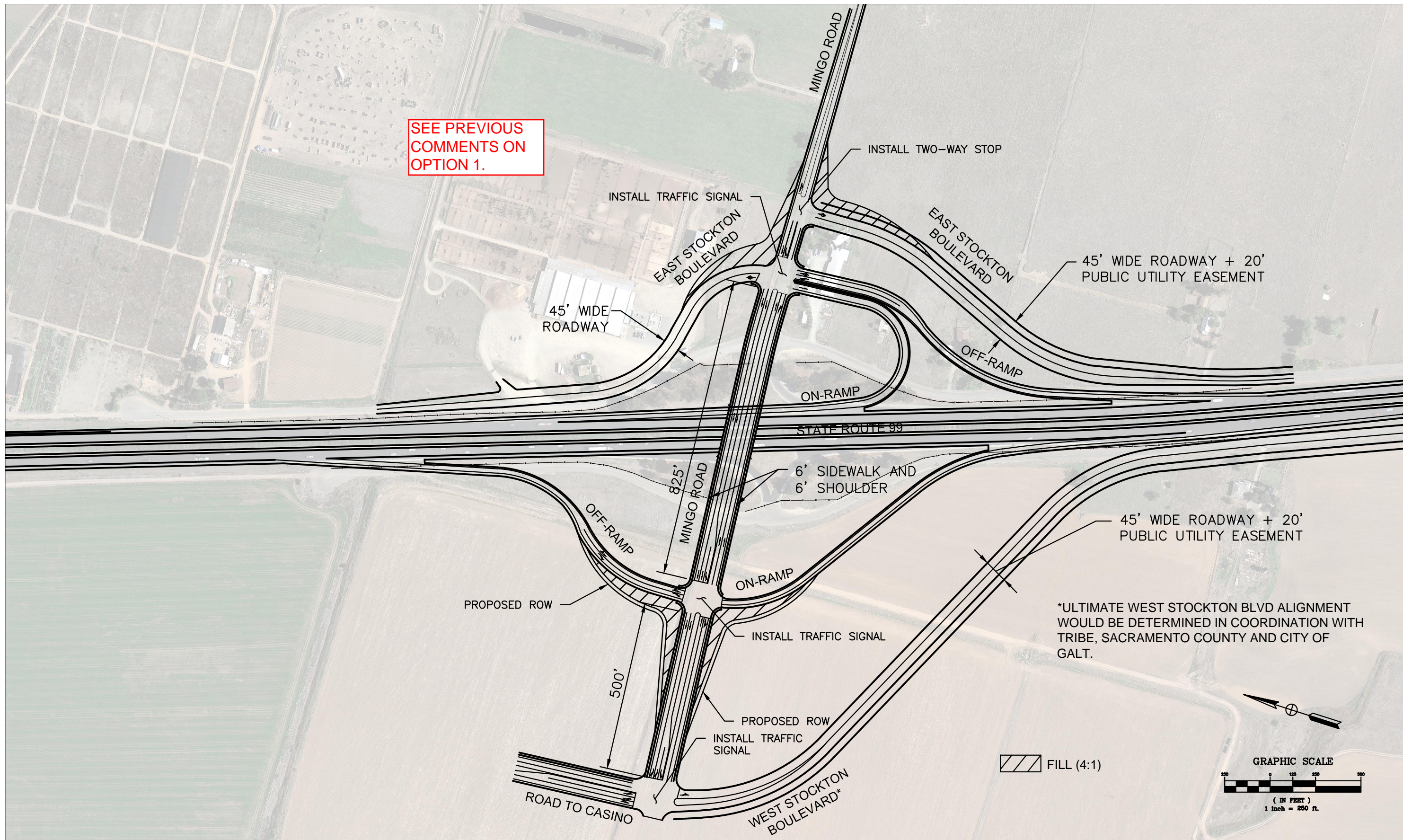

SR-99/MINGO ROAD INTERCHANGE - OPTION 4

JUNE 10th, 2015
KHA JOB # 092373003